

EN

MOUNTING INSTRUCTIONS FOR LIGHT HOLDER

uniorbiketools.com

POSITION	NAME	QUANTITY
1	LED light 60cm	1
2	Light holder	1
3	Sticker / Unior white	1
4	Lock nut M5	2
5	Upper light profile bracket	1
6	Hexagonal protective cap M8	4
7	Screw M8x70	1
8	Nut with protection M8	2
9	Screw M5x12	2
10	Upper light bracket profile	1
11	Screw M6x10	4
12	Lower light profile bracket	1
13	Lower light bracket profile	1
16	Screw M8x65	1
/	Instructions for mounting the light with bracket	1
/	Screw M8x16	1

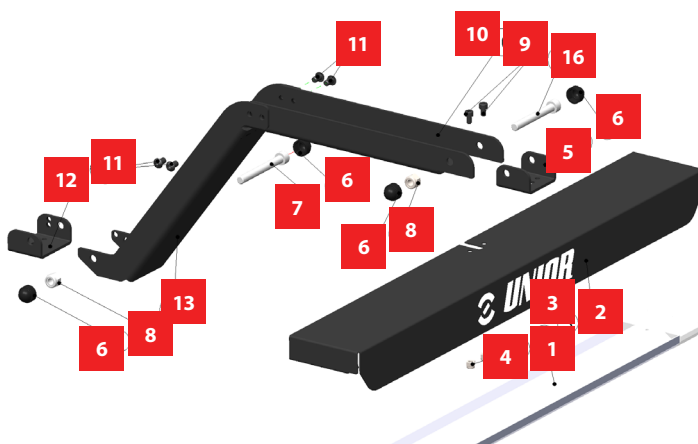
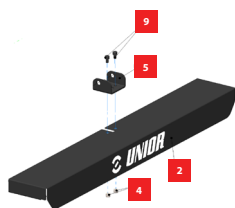

Figure 1

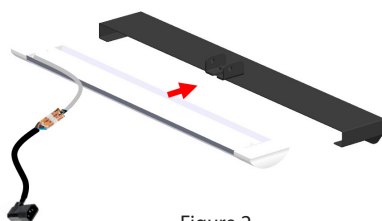

Figure 2

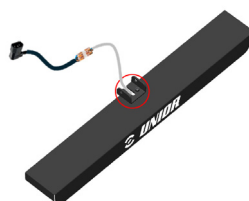

Figure 3

Assembly of the upper light profile bracket (pos.5) onto the light bracket (pos.2) with 2x screw M5x8 (pos.9) and 2x nut M5 (pos.4). See figure 1

Insert the light into the upper light bracket as shown in figure 2. The light cable should be inserted into the groove shown in figure 3. See figure 2 AND 3.



Figure 4

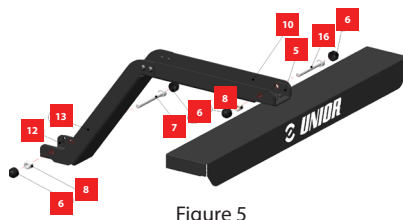

Figure 5



Figure 6

Assembly of the upper light bracket profile (pos. 10) and lower light bracket profile (pos. 13) with 4x M6x10 screws (pos. 11). See figure 4.

Assembly of the upper light bracket profile (pos. 10) and upper light bracket profile holder (pos. 5) with 1x M8x65 screw (pos. 16), 1x M8 nut (pos. 8), and 2x protective cap (pos. 6). See figure 5. Assembly of the lower light bracket profile (pos. 13) and lower light bracket profile holder (pos. 12) with 1x M8x70 screw (pos. 7), 1x M8 nut (pos. 8), and 2x protective cap (pos. 6). See figure 5. The cable should go under the M8x65 screw (pos. 16) and M8x70 screw (pos. 7). See figure 6.



Figure 7

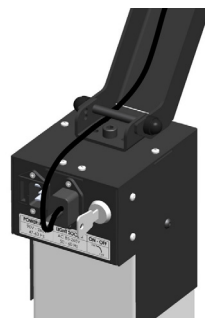

Figure 8

Secure the entire light bracket assembly to the upper part of the stand with 1xM8x16

Connect the light cable to the socket on the stand. See figure 8.