

Crimp lever pliers

428/4



Profiles



Product features

- material: premium sheet metal
- jaws drop forged from premium plus carbon steel, entirely hardened and tempered
- toggle joint ensures high compression pressure with little effort
- heavy duty plastic handles
- re-changeable head-spare part
- surface finish: phosphated to standard ISO 9717

Usage:

- for insulated terminals (0,5-6mm²)

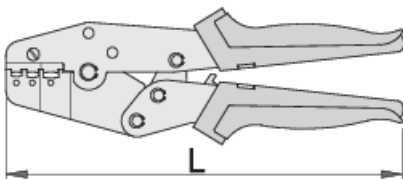

602327



0.5 - 6



226



575

* Images of products are symbolic. All dimensions are in mm, and weight in grams. All listed dimensions may vary in tolerance.

Usage (pictures)

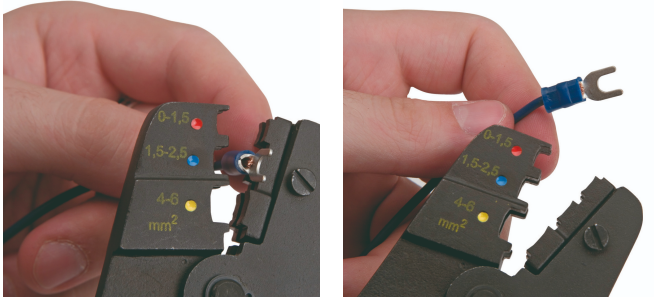

Spare parts



Spare parts for art. 428/4

Frequently asked questions

Why is it necessary to use crimping pliers for cable connections? Why not simply use combination pliers?

When working with cable connections, you must use crimping pliers because this is the only way to press the connections together correctly and accurately. This is a requirement for the safety of the joints and provided for by the grooves/shapes on the pliers.