

# 手动铆钉机套装

1301/6



## 配置文件



## 产品属性

- 轻型耐用结构
- 安装铆钉用4个导咀组件，3.2 mm – 6.4 mm (1/8" – 1/4")
- 安装盲孔铆钉螺母的5个导咀组件，从M4至M10 (R5/32" – R3/8")
- 工具配有SOS工具盘，可配合Unior工具车使用
- 上漆的重型把手



619880



495



2200

\* Images of products are symbolic. All dimensions are in mm, and weight in grams. All listed dimensions may vary in tolerance.

## 用途 (pictures)

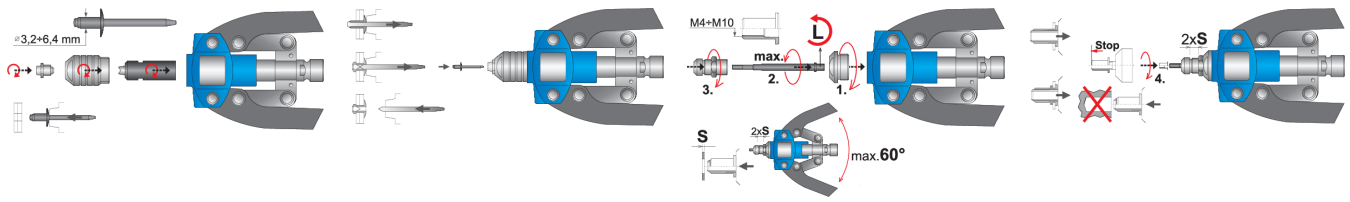

## 配件

 1301/6的盲孔铆钉螺母导咀组件

## Related products

 手动铆钉机