

# Tronchese a tagliente diagonale

461/1BI



## Profili

---



## Standard

---

DIN ISO 5749

## Attributi del prodotto

- materiale: acciaio al carbonio plus premium
- interamente bonificato
- bordi di taglio induriti a induzione
- teste lucidate
- finitura superficiale: cromata ISO 1456:2009
- robusta impugnatura bicomponente
- conforme allo standard ISO 5749

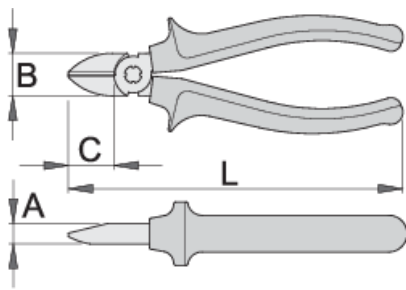

Barcode	L	B	A	C	Weight
607883	140	19	9.5	18	169
607884	160	22.5	10	22	214

capacità di taglio (10N=1kg)

Barcode	L	max 1600 N/mm <sup>2</sup> Ø↑	max 650 N/mm <sup>2</sup> Ø↑
607883	140	1,6	2,0
607884	160	1,6	2,5

\* Le immagini dei prodotti sono puramente simboliche. Tutte le dimensioni sono in mm, peso in grammi.

Utilizzo (pictures)

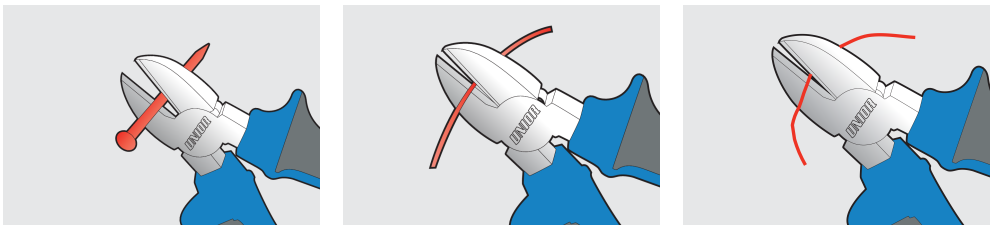

## Frequently asked questions

**What does it mean that the pliers are quenched and tempered and the head parts/teeth of the pliers are inductively hardened?**

It means that the pliers are thermally processed by quenching and tempering their entire surface to a hardness of about 45HRc, while head parts are additionally inductively hardened to a hardness of at least 60HRc.

**What is meant by the statement that pliers are made in accordance with the stated ISO standard?**

It means that the pliers are in accordance with the international standard in terms of dimensions, strength and structure, and compliance is determined by prescribed tests.