

斜嘴钳

461/1BI



配置文件



标准

DIN ISO 5749

产品属性

- 材料:优质高碳钢
- 落锻, 完全淬火与回火
- 切削刃感应淬火
- 头部抛光
- 表面处理: 根据ISO 1456:2009标准镀铬
- 重型双成分材料手柄
- 根据ISO 5749标准生产

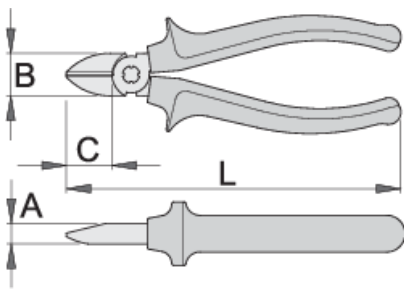

Barcode	L	B	A	C	Weight
607883	140	19	9.5	18	169
607884	160	22.5	10	22	214

cutting capacity (10N=1kg)

Barcode	L	max 1600 N/mm ² Ø↑	max 650 N/mm ² Ø↑
607883	140	1,6	2,0
607884	160	1,6	2,5

* Images of products are symbolic. All dimensions are in mm, and weight in grams. All listed dimensions may vary in tolerance.

用途 (pictures)

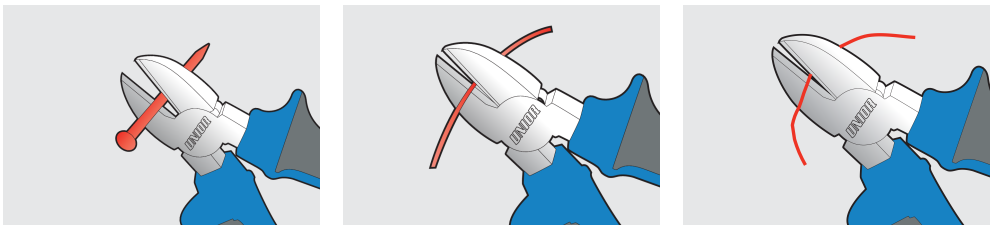

Frequently asked questions

What does it mean that the pliers are quenched and tempered and the head parts/teeth of the pliers are inductively hardened?

It means that the pliers are thermally processed by quenching and tempering their entire surface to a hardness of about 45HRc, while head parts are additionally inductively hardened to a hardness of at least 60HRc.

What is meant by the statement that pliers are made in accordance with the stated ISO standard?

It means that the pliers are in accordance with the international standard in terms of dimensions, strength and structure, and compliance is determined by prescribed tests.