

# Diagonal cutting nippers

461/1BI



## Profiles

---



## Standards



---

DIN ISO 5749

## Product features

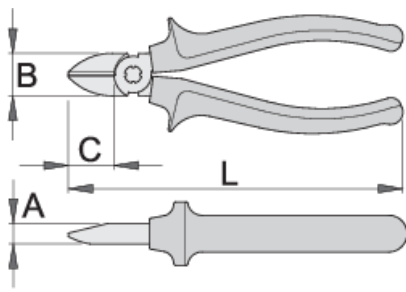
- material: premium plus carbon steel
- drop forged, entirely hardened and tempered
- cutting edges induction hardened
- head polished
- surface finish: chrome plated to standard ISO 1456:2009
- heavy duty double - component handles
- made according to standard ISO 5749



|  | L   | B    | A   | C  |  |
|--|-----|------|-----|----|---|
| 607883   | 140 | 19   | 9.5 | 18 | 169   |
| 607884   | 160 | 22.5 | 10  | 22 | 214   |

cutting capacity (10N=1kg)

|  | L   | max 1600 N/mm <sup>2</sup> Ø↑ | max 650 N/mm <sup>2</sup> Ø↑ |
|--|-----|-------------------------------|------------------------------|
| 607883   | 140 | 1,6                           | 2,0                          |
| 607884   | 160 | 1,6                           | 2,5                          |

\* Images of products are symbolic. All dimensions are in mm, and weight in grams. All listed dimensions may vary in tolerance.

Usage (pictures)

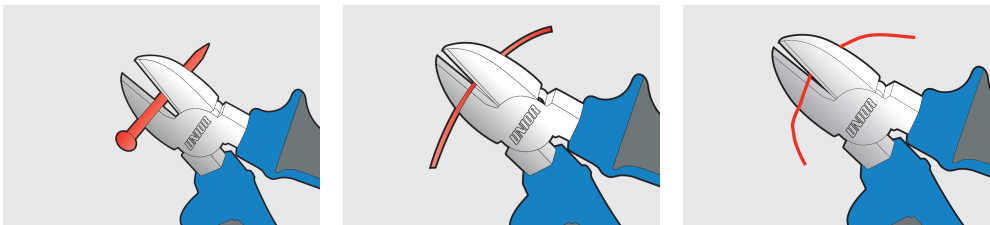

## Frequently asked questions

**What does it mean that the pliers are quenched and tempered and the head parts/teeth of the pliers are inductively hardened?**

It means that the pliers are thermally processed by quenching and tempering their entire surface to a hardness of about 45HRc, while head parts are additionally inductively hardened to a hardness of at least 60HRc.

**What is meant by the statement that pliers are made in accordance with the stated ISO standard?**

It means that the pliers are in accordance with the international standard in terms of dimensions, strength and structure, and compliance is determined by prescribed tests.