

Kliešte kombinované

405/4G

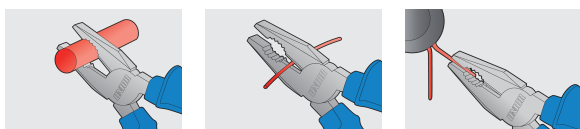

Usage



Profiles



[\(/sk/about-us/materials\)](https://sk/about-us/materials)



[\(/sk/support/warranty\)](https://sk/support/warranty)

Product features

- materiál: premium plus uhlíková ocel'
- tvrdené a kalené
- rezné hrany indukčne tvrdené
- leštené
- povrchová úprava: fosfátované
- pevná dvojzložková rukoväť
- podľa ISO 5746

Standards

ISO 5746

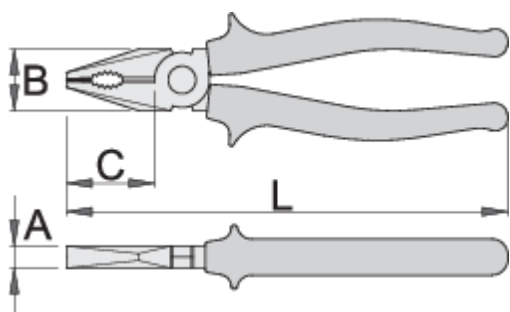

608668

L

160

B

24

C

35

A

9.5



224

Barcode	L	B	C	A	Icon
608669	180	27	38	10	273
608670	200	29	41	10.5	351

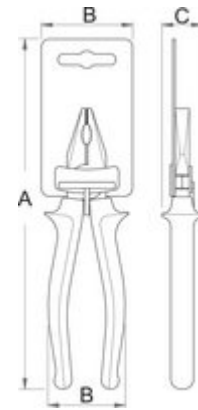

Retail packaging

Barcode	MA	MB	MC	Icon
608668	230	58	31	224
608669	240	58	31	266
608670	260	61	31	332

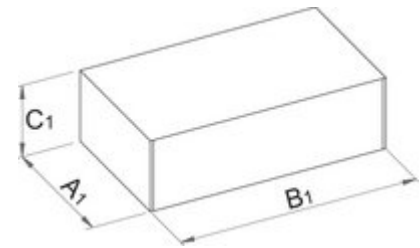

Transport packaging

Barcode	Hand icon	TA	TB	TC	Icon
608668	4	75	308	60	960
608669	4	84	318	63	1138
608670	4	90	330	84	1422