

双高颈套筒扳手

177



配置文件



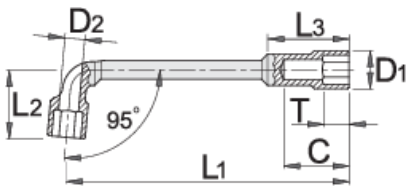

产品属性

- 材料：铬钒钢
- 落锻，完全淬火与回火
- 表面处理：根据ISO 1456:2009标准镀铬



Barcode	mm	L1	L2	C	D1	T	L3	D2	Weight
609083	8	113	26	27	13	10	30	6,5	76
609084	9	118	27	29	14,5	10	33	7	78
609085	10	123	31	32	16	11	35	7,5	123
609086	11	128,5	32	31	17	12	37	7,5	125
609087	12	135	33	34	18	12	40	8,5	161

			L1	L2	C	D1	T	L3	D2	
609088		13	143	36,5	40	19	11	47	9	186
609089		14	149,5	40	41	21	14	48	10,5	226
609090		15	163	41,5	43	22,5	15	50	11	236
609091		16	173	46,5	47	24	17	54	13	340
609092		17	184,5	46,5	49	25	18	56	13	360
609093		18	198	49	51,5	26,5	19,5	58	13	411
609094		19	204	52	52,5	28	20,5	62	14	445
609095		20	207	53,5	54,5	30	21,5	63	14	495
609096		21	216	57	57,7	30,5	23,5	65	15	487
609097		22	231	57	58	32	23,5	67	16	590
609098		23	238	62	64,5	33,5	24,5	74	18	640
609099		24	249	64,5	68,5	34,5	25,5	77	18	713

* Images of products are symbolic. All dimensions are in mm, and weight in grams. All listed dimensions may vary in tolerance.

用途 (pictures)

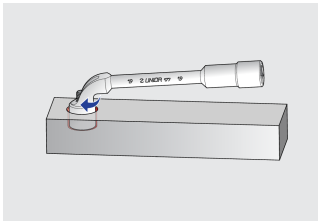

扳手的形状和开口使其可以在长螺纹上拧动螺母

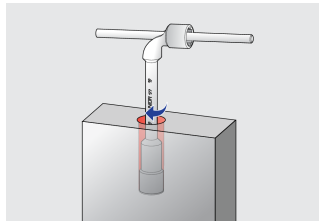

通过其较深的纵剖面，此扳手也可通过长螺母和螺纹，作为套筒扳手使用。

