

uhlový klíč obojstranný

176



Profiles





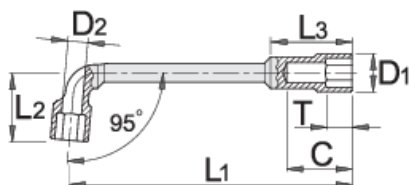

Product features

- materiál: premium chróm vanádiová ocel'
- kované, tvrdené a temperované,
- chrómované v súlade s ISO 1456:2009



| Barcode | mm | L1 | L2 | C | D1 | T | L3 | D2 | Weight | Time |
|---------|----|-------|----|----|------|----|------|-----|--------|------|
| 609103 | 7 | 108 | 25 | 23 | 12 | 8 | 30,5 | 5 | 47 | |
| 609104 | 8 | 113 | 26 | 27 | 13 | 10 | 30 | 6,5 | 76 | |
| 609105 | 9 | 118 | 27 | 29 | 14,5 | 10 | 33 | 7 | 78 | |
| 609107 | 11 | 128,5 | 32 | 31 | 17 | 12 | 37 | 7,5 | 125 | |
| 609108 | 12 | 135 | 33 | 34 | 18 | 12 | 40 | 8,5 | 161 | |

| |  |  | L1 | L2 | C | D1 | T | L3 | D2 |  |  |
|--------|--|---|-------|------|------|------|------|-----|----|---|---|
| 609112 | | 16 | 173 | 46,5 | 47 | 24 | 17 | 54 | 13 | 340 | |
| 609113 | | 17 | 184,5 | 46,5 | 49 | 25 | 18 | 56 | 13 | 360 | |
| 609114 | | 18 | 198 | 49 | 51,5 | 26,5 | 19,5 | 58 | 13 | 411 | |
| 609115 | | 19 | 204 | 52 | 52,5 | 28 | 20,5 | 62 | 14 | 445 | |
| 609118 | | 22 | 231 | 57 | 58 | 32 | 23,5 | 67 | 16 | 590 | |
| 609120 | | 24 | 249 | 64,5 | 68,5 | 34 | 25,5 | 77 | 18 | 713 | |
| 609123 | | 27 | 280 | 68 | 71 | 37 | 25,5 | 80 | 20 | 867 | |
| 609126 | | 30 | 311 | 75 | 80,5 | 42 | 28,5 | 93 | 23 | 1257 | |
| 609127 | | 32 | 330,5 | 79 | 82,5 | 45 | 28,5 | 95 | 24 | 1434 | |
| 609129 | | 36 | 376 | 80 | 86 | 50 | 30 | 100 | 25 | 2235 | |

* Obrázky sú symbolické. Všetky rozmery sú v mm, hmotnosť je v g. Všetky udané rozmery sa môžu líšiť v rámci tolerancie.

Usage (pictures)

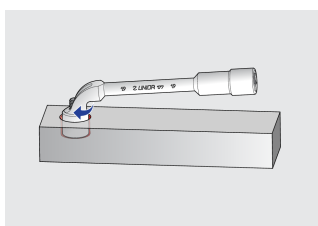

Tvar a otvorenie kľúča umožňuje skrútkovanie matíc na dlhých závitoch.

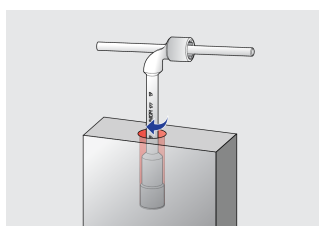

Vďaka hlbokému profilu kľúča funguje tiež ako gola hlavica pre matice na dlhých závitoch.

Photo (pictures)

