

Chei tubulare pipa cu 6 laturi

176



Profile





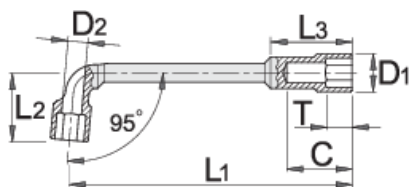

Caracteristicile produsului

- material: crom vanadiu
- forjata, calire si revenire totala
- acoperire cromare conform ISO 1456:2009



Barcode	mm	L1	L2	C	D1	T	L3	D2	Weight	Availability
609102	6	104,5	22	22	11	7	29	5	44	Till end of stock
609103	7	108	25	23	12	8	30,5	5	47	
609104	8	113	26	27	13	10	30	6,5	76	
609105	9	118	27	29	14,5	10	33	7	78	
609106	10	123	31	32	16	11	35	7,5	123	

			L1	L2	C	D1	T	L3	D2		
609107	11	128,5	32	31	17	12	37	7,5	125		
609108	12	135	33	34	18	12	40	8,5	161		
609109	13	143	36,5	40	19	14	47	9	186		
609110	14	149,5	40	41	21	14	48	10,5	226	Till end of stock	
609111	15	163	41,5	43	22,5	15	50	11	236	Till end of stock	
609112	16	173	46,5	47	24	17	54	13	340		
609113	17	184,5	46,5	49	25	18	56	13	360		
609114	18	198	49	51,5	26,5	19,5	58	13	411		
609115	19	204	52	52,5	28	20,5	62	14	445		
609116	20	207	53,5	54,5	30	21,5	63	14	495	Till end of stock	
609117	21	216	57	57,5	30,5	23,5	65	15	487	Till end of stock	
609118	22	231	57	58	32	23,5	67	16	590		
609119	23	238	62	64,5	33,5	24,5	74	18	640		
609120	24	249	64,5	68,5	34	25,5	77	18	713		
609121	25	260	67	69,5	36	25,5	79	19,5	703	Till end of stock	
609122	26	270,5	68	70	36	27	81	22	876	Till end of stock	
609123	27	280	68	71	37	25,5	80	20	867		
609124	28	290,5	70	73,5	38,5	27,5	84	21	1045		
609125	29	298,5	72	78,5	41	28,5	90	22	1140		
609126	30	311	75	80,5	42	28,5	93	23	1257		
609127	32	330,5	79	82,5	45	28,5	95	24	1434		
609128	35	340	90	97,5	48	35,5	108	25	2200	Till end of stock	
609129	36	376	80	86	50	30	100	25	2235		

* Imaginea produsului este simbolica.Toate dimensiunile sunt exprimate în mm,greutatea în grame.

0 (pictures)

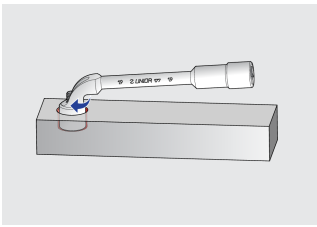

Forma si deschiderea cheii permit insurubarea piulitelor pe filete lungi

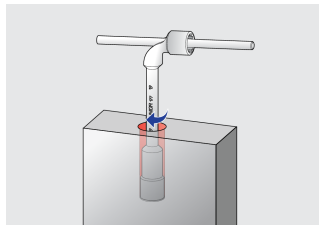

Datorita profilului adanc, cheia se foloseste si ca cheia de capete tubulare, pentru capete tubulare si filete

Photo (pictures)

