

# 合金轮 1/2" 气动套筒，加长

231/4PL



## 配置文件



## 产品属性

- 材料：铬钼钢
- 落锻，完全淬火与回火
- 表面处理：根据DIN12476标准进行磷酸盐处理
- 带塑料保护

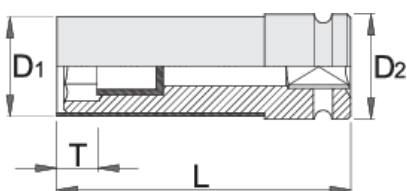



D1

D2

L

T



		D1	D2	L	T	
619015	17	27	25	130	24	305
619016	19	29	30	130	24	360
619017	21	31	30	130	24	405

\* Images of products are symbolic. All dimensions are in mm, and weight in grams. All listed dimensions may vary in tolerance.

### Safety (pictures)

