

# İç TX profilli darbeli lokma 1/2"

231/4TX



## Profiles



## Product features

- malzeme: krom molibden
- sıcak dövme, tamamen sertleştirilmiş ve temperlenmiş
- yüzey bitirme: ISO 9717 standardına göre fosfat kaplamalı

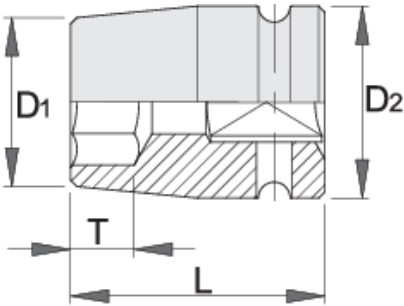

612880



E 10

D1

15

D2

25

L



38

T

7.5



90

		D1	D2	L	T	
612881	E 12	16	25	38	8.5	90
612882	E 14	18.5	25	38	10	95
612883	E 16	20	25	38	11	95
612884	E 18	22	25	38	12	95
612885	E 20	25	30	38	13.5	145
612886	E 24	28.5	30	45	21	170

\* Ürünlerin resimleri semboliktir. Bütün boyutlar mm ve ağırlık gram cinsindedir.

### Safety (pictures)

