

1/2"内TX冲击套筒

231/4TX



配置文件



产品属性

- 材料：铬钼钢
- 落锻，完全淬火与回火
- 表面处理：根据DIN12476标准进行磷酸盐处理

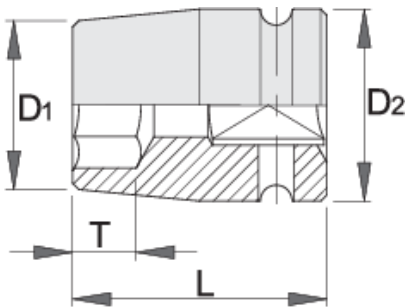

612880



E 10

D1

15

D2

25

L



38

T

7.5



90

		D1	D2	L	T	
612881	E 12	16	25	38	8.5	90
612882	E 14	18.5	25	38	10	95
612883	E 16	20	25	38	11	95
612884	E 18	22	25	38	12	95
612885	E 20	25	30	38	13.5	145
612886	E 24	28.5	30	45	21	170

* Images of products are symbolic. All dimensions are in mm, and weight in grams. All listed dimensions may vary in tolerance.

Safety (pictures)

