

Flexible reversible ratchet 1/2"

190.1/1FBI



Profiles



Product features

- material: premium flex chrome vanadium steel
- body drop forged
- entirely hardened and tempered
- ergonomic heavy duty double component handle
- surface finish: trivalent chrome plated to standard ISO 1456:2009

Advantages:

- 75 - teeth
- 4,8° working angle
- flexible ratchet allows working with the handle inclination up to max 90° with the 22,5° steps
- Safety lock system
- The socket is simple released from the ratchet by pressing the button.

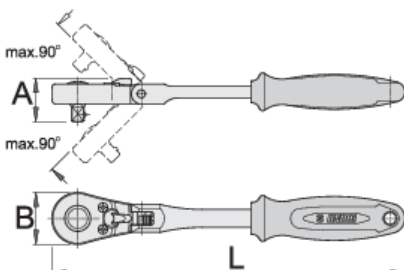



618369



1/2"

L

320

A

36

B

40



598

* Images of products are symbolic. All dimensions are in mm, and weight in grams. All listed dimensions may vary in tolerance.

Usage (pictures)

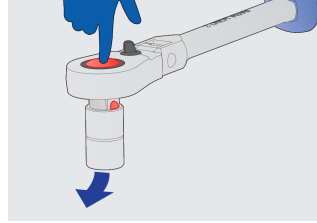
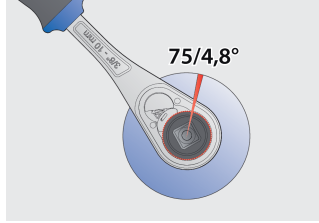
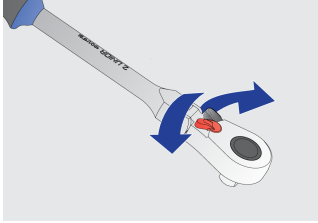

Spare parts



Set of spare parts for 190.1/1ABI and 190.1/1FBI

Frequently asked questions

I wanted to loosen the wheels on the car using a ratchet, and now it isn't working. Perhaps the mechanism broke down? Did I use the right ratchet?

The ratchet article 190.1/1LG is intended for unscrewing car wheel bolts. Other ratchets in Unior's range are not designed to unscrew car wheel bolts.