

# Dopsleutel-schroevendraaier 3/8" ZX

236/2ZX

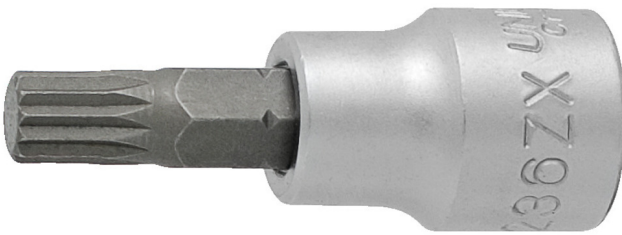





## Profielen

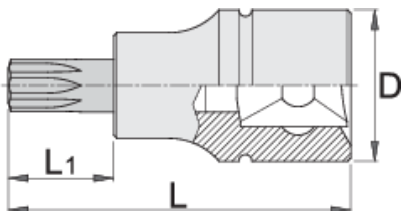

## Product attributen

- materiaal: dop: chroom vanadium, verchromd
- material: bit from premium plus carbon steel
- entirely hardened and tempered
- made according to standard DIN 2324



|  |  | L  | L1 | D  |  |
|--|---|----|----|----|---|
| 612113   | M5  | 48 | 22 | 18 | 37  |
| 612114   | M6  | 48 | 22 | 18 | 39  |
| 612115   | M8  | 48 | 22 | 18 | 46  |

\* Afbeeldingen van producten zijn symbolisch. Alle afmetingen zijn in mm en gewicht in gram. Alle vermelde afmetingen kunnen variëren in tolerantie.