

# Dopsleutel-schroevendraaier 1/4" TX

187/2TX

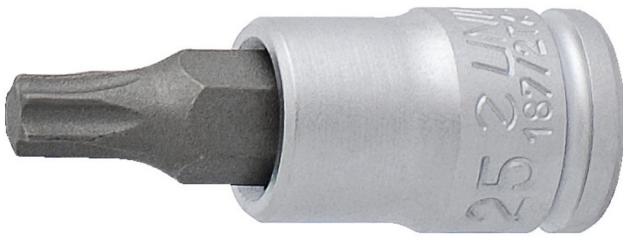





## Profielen



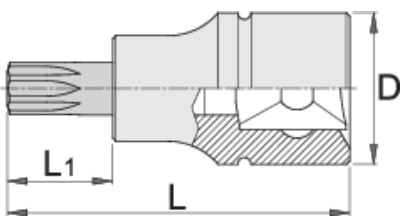

## Product attributen

- materiaal: dop: chroom vanadium, verchromd
- material: bit from premium plus carbon steel
- entirely hardened and tempered



|  |  | L  | L1 | D  |  |
|--|---|----|----|----|---|
| 607903   | TX 8  | 32 | 13 | 12 | 15  |
| 607904   | TX 10   | 32 | 13 | 12 | 15  |
| 607905   | TX 15   | 32 | 13 | 12 | 15  |
| 607906   | TX 20   | 32 | 13 | 12 | 15  |

|  |  | L  | L1 | D  |  |
|--|---|----|----|----|---|
| 607907   | TX 25   | 32 | 13 | 12 | 15  |
| 607908   | TX 27   | 32 | 13 | 12 | 15  |
| 607909   | TX 30   | 32 | 13 | 12 | 15  |
| 607910   | TX 40   | 32 | 13 | 12 | 17  |

\* Afbeeldingen van producten zijn symbolisch. Alle afmetingen zijn in mm en gewicht in gram. Alle vermelde afmetingen kunnen variëren in tolerantie.