

# 批头转接头

188.9



## 配置文件



## 产品属性

- 材料：特种工具钢
- 落锻，完全淬火与回火
- 表面处理：根据ISO 1456:2009标准镀铬

## 用途：

- 适用于刀头E6,3, C6,3

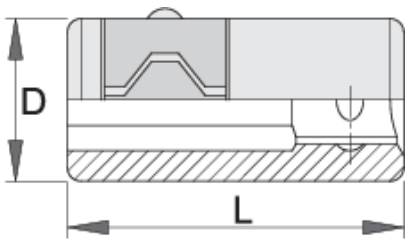

612867



1/4" - 1/4"

L

25

D

12



18

\* Images of products are symbolic. All dimensions are in mm, and weight in grams. All listed dimensions may vary in tolerance.