

Moersleutel, verstelbaar

250/1



Profielen



Standaard

ISO 6787

Product attributen

- materiaal: premium chroom vanadium staal
- drop forged, entirely hardened and tempered
- surface finish: chrome plated according to ISO 1456:2009
- gepolijste kop
- with scale
- made according to standard ISO 6787

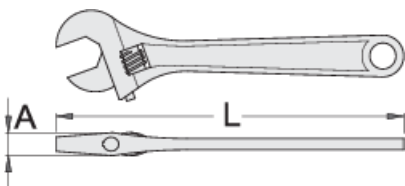

611917



100



4"



108.4







10.5



13



61

			L	A		
611918	150	6"	157.4	13	19	133
601016	200	8"	205.9	15	24	243
601017	250	10"	255.5	17	27	439
601018	300	12"	306.1	20	34	702
601019	380	16"	383	26	41	1315
605113	450	18"	460.5	32	48	1730
615148	600	24"	612.3	36	57	3240

* Afbeeldingen van producten zijn symbolisch. Alle afmetingen zijn in mm en gewicht in gram. Alle vermelde afmetingen kunnen variëren in tolerantie.

Gebruik (Afbeeldingen)

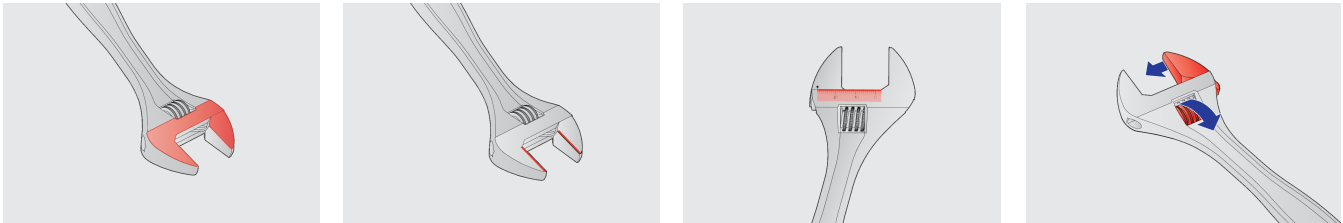

Onderdelen



Reserveonderdelen voor verstelbare moersleutel 250/1, 250 / 1A

Veiligheidstips



- Discard any wrench with a spread or damaged fixed jaw or a bent handle

Veiligheid (Afbeeldingen)

