

어드저스터블 렌치

250/1



프로파일



표준

ISO 6787

제품 특징

- 재질: 프리미엄 크롬 바나듐 스틸
- 낙하 단조, 완전 경화 및 담금질
- 표면 마감: ISO 1456:2009에 따른 크롬 도금
- 헤드 폴리싱 처리
- 치수 눈금 포함
- ISO 6787표준에 따라 제작

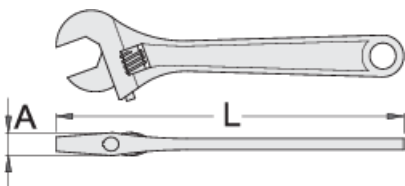

611917



100



4"



108.4







10.5



13



61

			L	A		
611918	150	6"	157.4	13	19	133
601016	200	8"	205.9	15	24	243
601017	250	10"	255.5	17	27	439
601018	300	12"	306.1	20	34	702
601019	380	16"	383	26	41	1315
605113	450	18"	460.5	32	48	1730
615148	600	24"	612.3	36	57	3240

* Images of products are symbolic. All dimensions are in mm, and weight is in grams. All listed dimensions may vary in tolerance.

사용법 (사진)

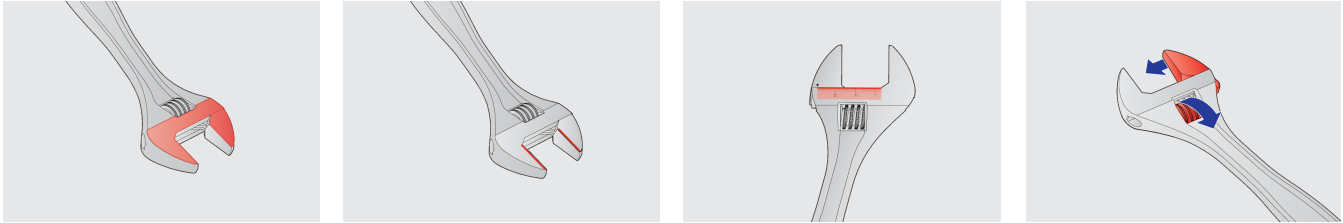

스페어 파트



Spare parts for adjustable wrench 250/1, 250/1A

안전 수칙



- 고정 조가 손상되었거나 핸들이 구부러진 렌치는 폐기하십시오.

안전 (사진)

