

# Chiave regolabile

250/1



## Profili



## Standard

ISO 6787

## Attributi del prodotto

- materiale: acciaio al cromo vanadio premium
- forgiato a caldo, interamente bonificato e temprato
- finitura superficiale: cromata EN12540
- testa lucidata
- con scala
- conforme allo standard ISO 6787

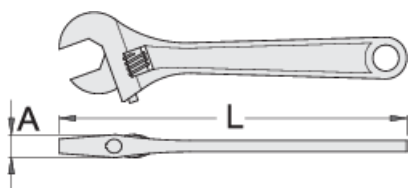

611917



100



4"



108.4







10.5



13



61

			L	A		
611918	150	6"	157.4	13	19	133
601016	200	8"	205.9	15	24	243
601017	250	10"	255.5	17	27	439
601018	300	12"	306.1	20	34	702
601019	380	16"	383	26	41	1315
605113	450	18"	460.5	32	48	1730
615148	600	24"	612.3	36	57	3240

\* Le immagini dei prodotti sono puramente simboliche. Tutte le dimensioni sono in mm, peso in grammi.

### Utilizzo (pictures)

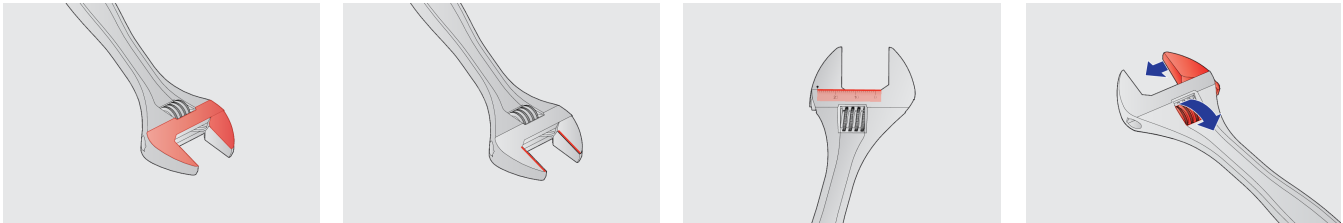

### Parti di ricambio



Parti di ricambio per chiavi regolabili 250/1, 250/1A

### Safety tips



- Discard any wrench with a spread or damaged fixed jaw or a bent handle

### Safety (pictures)

