

Adjustable wrench

250/1



Profiles



Standards

ISO 6787

Product features

- material: premium chrome vanadium steel
- drop forged, entirely hardened and tempered
- surface finish: trivalent chrome plated according to ISO 1456:2009
- polished head
- with scale
- made according to standard ISO 6787

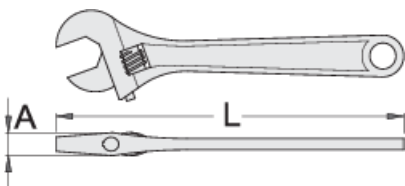

611917



100



4"



108.4





10.5



13



61

			L	A		
611918	150	6"	157.4	13	19	133
601016	200	8"	205.9	15	24	243
601017	250	10"	255.5	17	27	439
601018	300	12"	306.1	20	34	702
601019	380	16"	383	26	41	1315
605113	450	18"	460.5	32	48	1730
615148	600	24"	612.3	36	57	3240

* Images of products are symbolic. All dimensions are in mm, and weight in grams. All listed dimensions may vary in tolerance.

Usage (pictures)

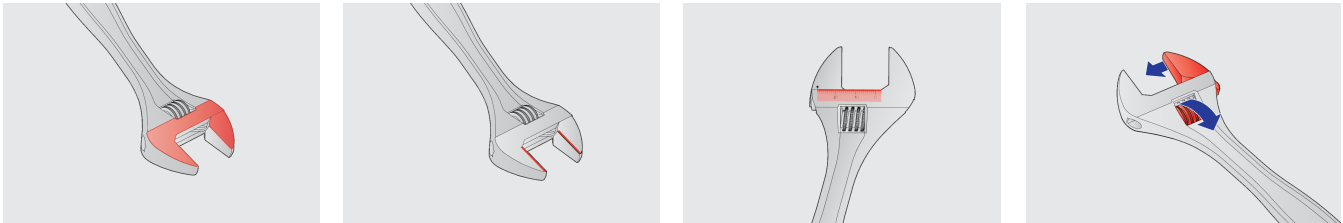

Spare parts



Spare parts for adjustable wrench 250/1, 250/1A

Safety tips



- Discard any wrench with a spread or damaged fixed jaw or a bent handle

Safety (pictures)

