

Tool cabinet

Hidden

948E1





Profiles

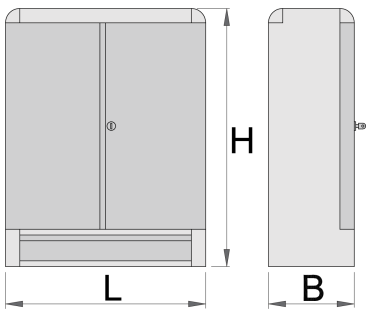

Product features

- material: premium PLUS sheet metal
- locking with keylock and folding key
- lock with key included also foam keyring
- drawers with ball-bearing slides
- coated with eco colour of Qualicoat quality standard
- 1 drawer, dimension 560x245x70
- the interior of the cabinet is fitted with perforated steel plate



	L	B	H	
612215	700	300	900	27500

* Images of products are symbolic. All dimensions are in mm, and weight in grams. All listed dimensions may vary in tolerance.

Accessories

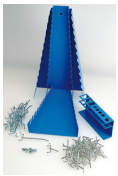

Accessories for 948E1



Holder for cordless screwdriver



Holder for hammers



Holder with pin, 10 pcs set



Holder for pliers, 10 pcs set



Holder for screwdrivers

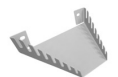

Holder for wrenches



Hook, 10 pcs set



Double hook, 10 pcs set

Related products



Tool cabinet



Cabinet with roller shutter



Hanging cabinet for work benches