

# iki sürgülü kollu çektilme

683/2



## Profiles



## Product features

- malzeme: özel alet çeliği
- sıcak dövme, tamamen sertleştirilmiş ve temperlenmiş
- yüzey bitirme: ISO 1456:2009 standardına göre krom kaplamalı, karartılmış vida
- levye mekanizmalı kısıkaçlar, sökülecek parçanın altına sıkıca oturur

## Avantajları:

- kolların yönü değiştirilerek çektilme, iç ya da dış çektilme olarak kullanılabilir

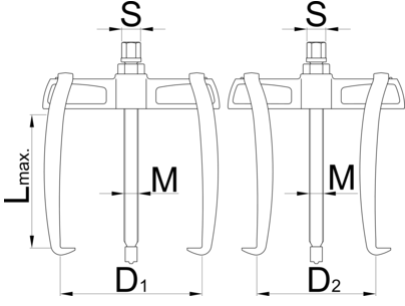

Barcode	No	L↑	D1	D2	$F_{max}$ →	$t_{max}$ →	M	S	Icon
615076	60	90	65	50 - 90	25	2.5	M 10x1	13	325
615077	90	90	90	50 - 110	25	2.5	M 10x1	13	395
615078	130	140	130	80 - 140	50	5	M 14x1,5	17	1125
615079	180	140	180	80 - 180	50	5	M 14x1,5	17	1225
615080	250	195	250	130 - 250	75	7.5	M 22x2	24	4025
615081	350	195	350	130 - 350	75	7.5	M 22x2	24	4525

\* Ürünlerin resimleri semboliktir. Bütün boyutlar mm ve ağırlık gram cinsindedir.

## Usage (pictures)



## Spare parts

 Kol

 Mil

## Related products



İki ayarlanabilir kollu çekirme



iki sürgülü kollu çekirme



Üç ayarlanabilir kollu çekirme

## Safety (pictures)

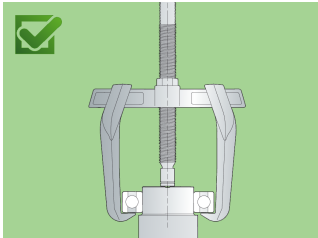
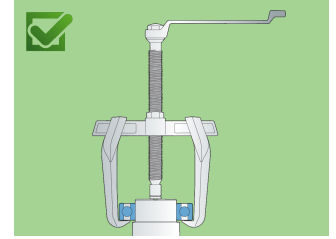
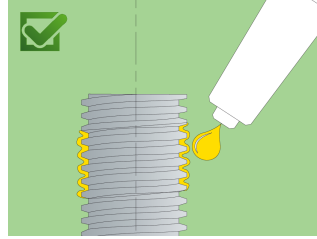
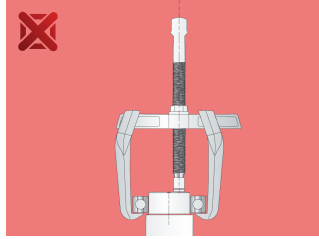
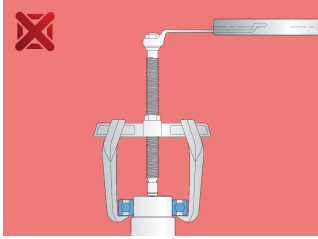
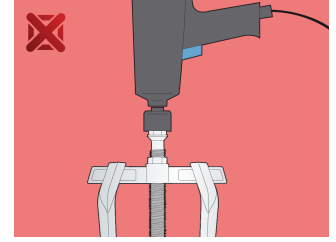
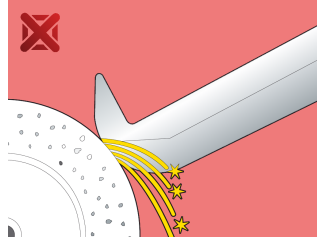
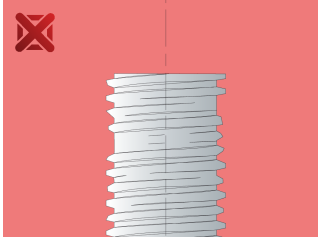

## Frequently asked questions

**Can we achieve greater pulling force using a three-arm puller compared to a two-arm puller?**

It depends on the dimensions. In principle, yes, because the force is distributed over several arms.

**One arm broke. Do I have to replace all the arms or just the broken one?**

It is necessary to change all the arms.

