

# Estrattore con due bracci scorrevoli

683/2



## Profili





## Attributi del prodotto

- materiale: corpo in acciaio al carbonio plus flex premium, bracci in acciaio al cromo vanadio premium
- forgiata, interamente bonificata
- finitura superficiale: cromata ISO 1456:2009 - vite: forgiata
- la leva di azionamento si aggancia fermamente sotto la parte da rimuovere

## Vantaggi:

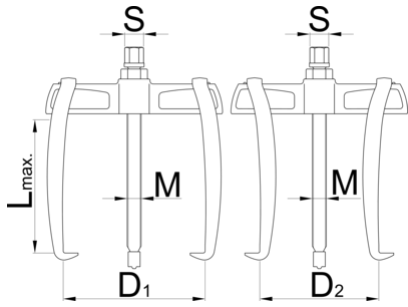
- invertendo i bracci l'estrattore può essere usato come estrattore interno o esterno



	N°	L↑	D1	D2	$F_{max}$ →	$t_{max}$ →	M	S	
615076	60	90	65	50 - 90	25	2.5	M 10x1	13	325
615077	90	90	90	50 - 110	25	2.5	M 10x1	13	395
615078	130	140	130	80 - 140	50	5	M 14x1,5	17	1125
615079	180	140	180	80 - 180	50	5	M 14x1,5	17	1225
615080	250	195	250	130 - 250	75	7.5	M 22x2	24	4025
615081	350	195	350	130 - 350	75	7.5	M 22x2	24	4525

\* Le immagini dei prodotti sono puramente simboliche. Tutte le dimensioni sono in mm, peso in grammi.

## Utilizzo (pictures)



## Parti di ricambio

 Braccio

 Alberino

## Related products



Estrattore con due bracci regolabili



Estrattore con due bracci scorrevoli



Estrattore con tre bracci regolabili

## Safety (pictures)

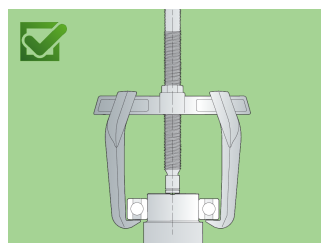
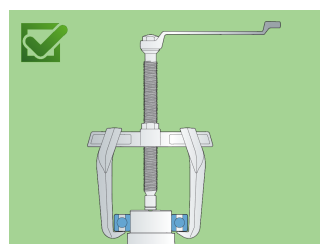
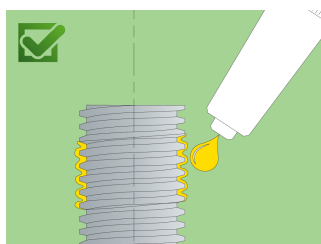
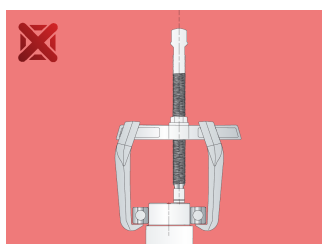
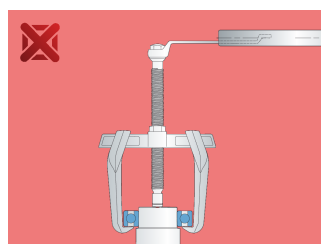
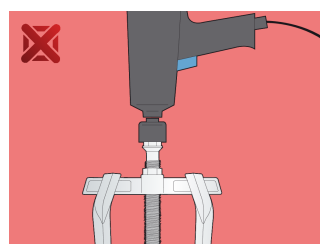
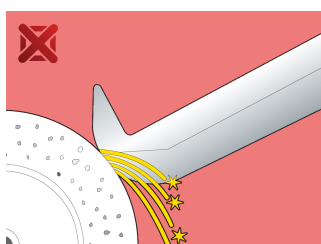
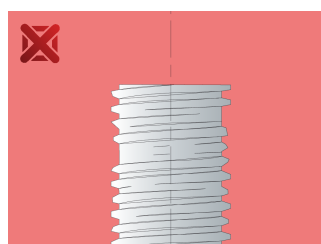

## Frequently asked questions

**Can we achieve greater pulling force using a three-arm puller compared to a two-arm puller?**  
It depends on the dimensions. In principle, yes, because the force is distributed over several arms.

**One arm broke. Do I have to replace all the arms or just the broken one?**

It is necessary to change all the arms.