

Puller with two sliding arms

683/2



Profiles



Product features

- material: body from premium flex plus carbon steel, arm from premium chrome vanadium steel
- drop forged, entirely hardened and tempered
- surface finish: trivalent chrome plated according to ISO 1456:2009, screw blackened
- lever action claws fit closely under the part to be removed

Advantages:

- by reversing the arms, the puller can be used as internal or external puller

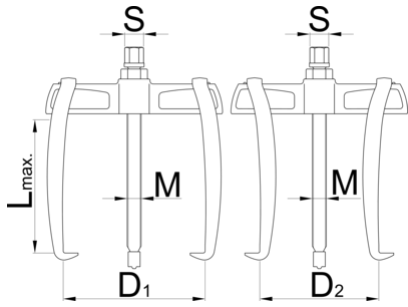

	Nº	L↑	D1	D2	F_{max} →	t_{max} →	M	S	
615076	60	90	65	50 - 90	25	2.5	M 10x1	13	325
615077	90	90	90	50 - 110	25	2.5	M 10x1	13	395
615078	130	140	130	80 - 140	50	5	M 14x1,5	17	1125
615079	180	140	180	80 - 180	50	5	M 14x1,5	17	1225
615080	250	195	250	130 - 250	75	7.5	M 22x2	24	4025
615081	350	195	350	130 - 350	75	7.5	M 22x2	24	4525

* Images of products are symbolic. All dimensions are in mm, and weight in grams. All listed dimensions may vary in tolerance.

Usage (pictures)



Spare parts



Arm



Spindle

Related products



Puller with two adjustable arms



Puller with two sliding arms



Puller with three adjustable arms

Safety (pictures)

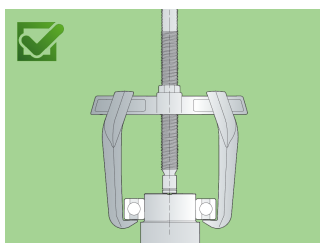
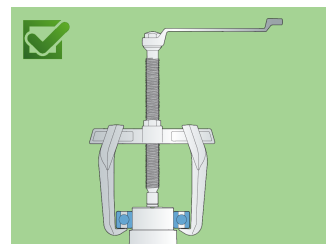
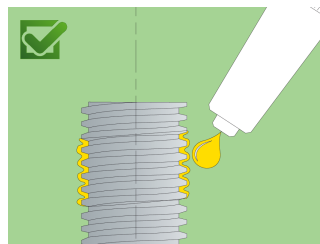
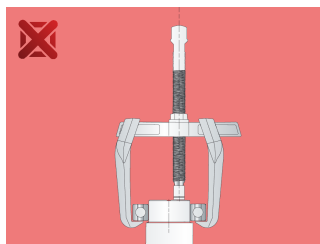
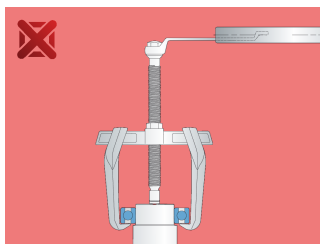
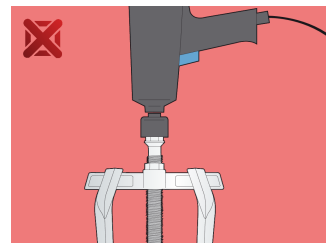
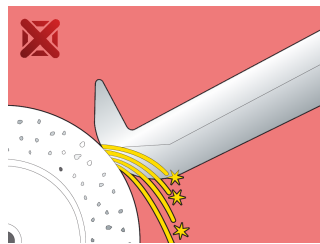
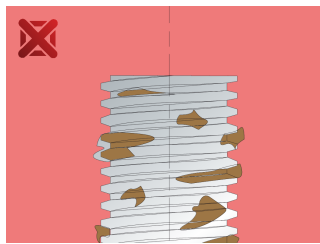
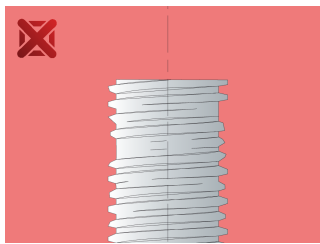

Frequently asked questions

Can we achieve greater pulling force using a three-arm puller compared to a two-arm puller?
It depends on the dimensions. In principle, yes, because the force is distributed over several arms.

One arm broke. Do I have to replace all the arms or just the broken one?

It is necessary to change all the arms.