

iki sürgülü kollu çekirme

681/2



Profiles



Product features

- malzeme: özel alet çeliği
- sıcak dövme, tamamen sertleştirilmiş ve temperlenmiş
- yüzey bitirme: ISO 1456:2009 standardına göre krom kaplamalı, karartılmış vida

Avantajları:

- kolların yönü değiştirilerek çekirme, iç ya da dış çekirme olarak kullanılabilir
- çok ağır hizmet tipi çalışma için sağlam tasarım

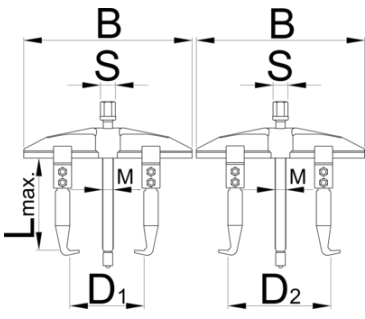

Barcode	Nº	B	D1	D2	L↑	Fmax→	tmax→	M	S	Icon
601765	300	280	70 - 220	110 - 260	150	65	6.5	M 20 x 2	22	3355
601766	400	450	110 - 360	190 - 450	200	110	11	M 22 x 2	32	8725

* Ürünlerin resimleri semboliktir. Bütün boyutlar mm ve ağırlık gram cinsindedir.

Usage (pictures)

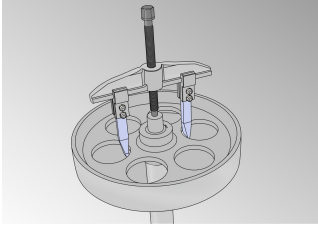

Spare parts



Kol



Mil

Related products



İki ayarlanabilir kollu ektirme



iki srgl kollu ektirme



 ayarlanabilir kollu ektirme

Safety (pictures)

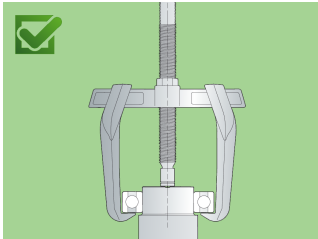
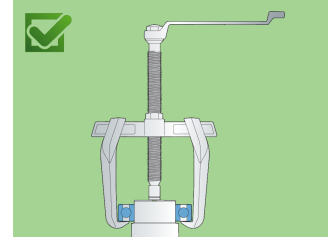
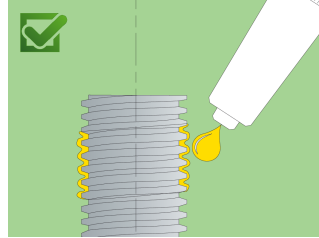
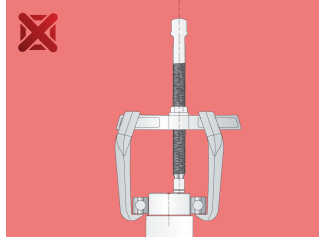
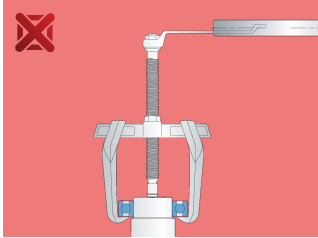
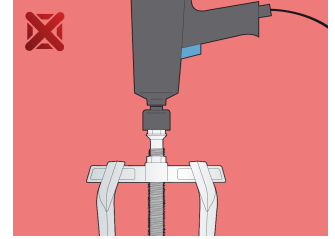
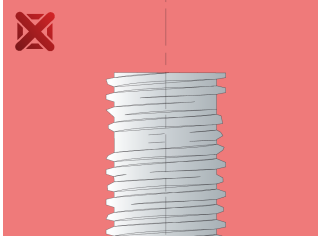

Frequently asked questions

One arm broke. Do I have to replace all the arms or just the broken one?

It is necessary to change all the arms.