

带两个滑动拉爪的拉拔器

681/2



配置文件



产品属性

- 材料：特种工具钢
- 落锻，完全淬火与回火
- 表面处理：根据ISO 1456:2009标准镀铬，螺钉发黑。

优势：

- 通过翻转拉爪，拉拔器可作为内部或外部拉拔器使用
- 适用于重型作业的牢固设计

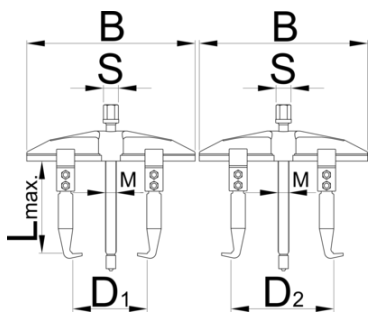

Barcode	Nº	B	D1	D2	L↑	Fmax→	tmax→	M	S	Icon
601765	300	280	70 - 220	110 - 260	150	65	6.5	M 20 x 2	22	3355
601766	400	450	110 - 360	190 - 450	200	110	11	M 22 x 2	32	8725

* Images of products are symbolic. All dimensions are in mm, and weight in grams. All listed dimensions may vary in tolerance.

用途 (pictures)

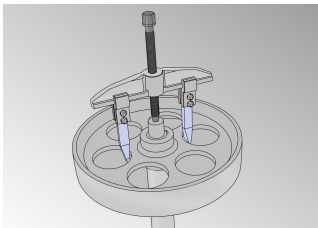

配件



拉爪



主轴

Related products



带两个拉爪的拉拔器



带两个滑动拉爪的拉拔器



带三个拉爪的拉拔器

Safety (pictures)

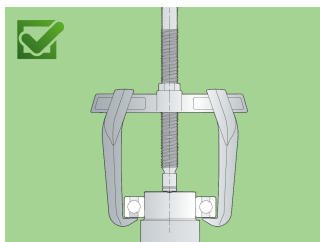
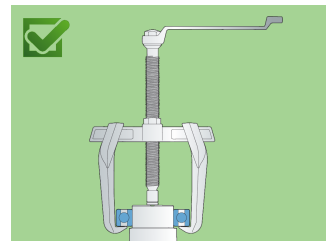
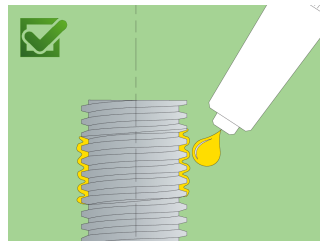
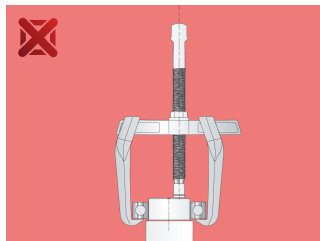
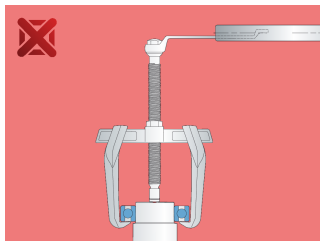
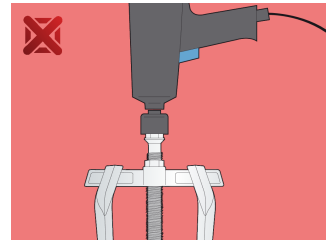
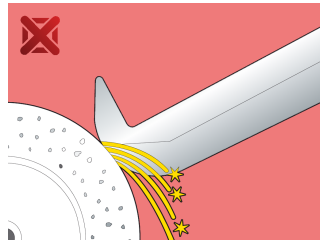
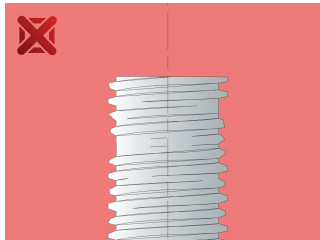

Frequently asked questions

One arm broke. Do I have to replace all the arms or just the broken one?

It is necessary to change all the arms.