

# Estrattore con due bracci regolabili

680/2



## Profili



## Attributi del prodotto

- materiale: corpo in acciaio al carbonio plus flex premium, bracci in acciaio al cromo vanadio premium
- forgiata, interamente bonificata
- finitura superficiale: cromata ISO 1456:2009 - vite: forgiata

- bracci regolabili in due posizioni
- la leva di azionamento si aggancia fermamente sotto la parte da rimuovere



	N°	L↑	D↑			M	S	
612603	0	90	90	20	2	M 10 x 1	13	405
601762	1	130	160	30	3	M 14 x 1,5	17	915
601763	2	190	230	40	4	M20 x 2	22	2078
601764	3	250	300	60	6	M 22 x 2	24	4075

\* Le immagini dei prodotti sono puramente simboliche. Tutte le dimensioni sono in mm, peso in grammi.

### Utilizzo (pictures)

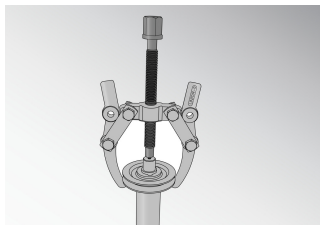

### Parti di ricambio

Braccio

Alberino

## Related products



Estrattore con due bracci scorrevoli



Estrattore con due bracci scorrevoli



Estrattore con tre bracci regolabili

## Safety (pictures)

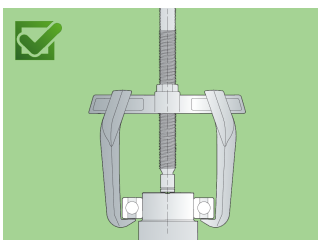
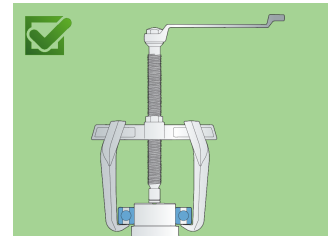
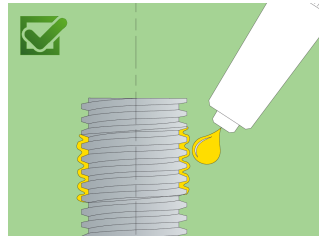
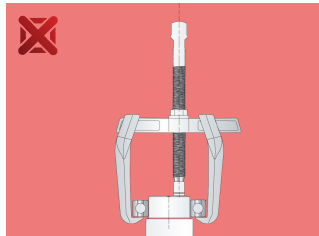
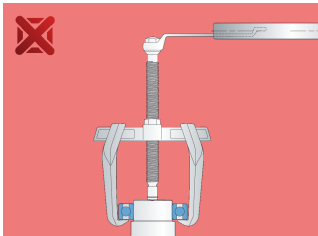
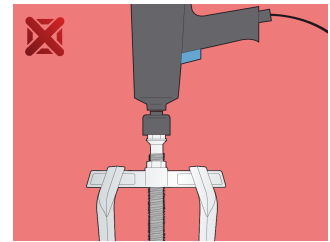
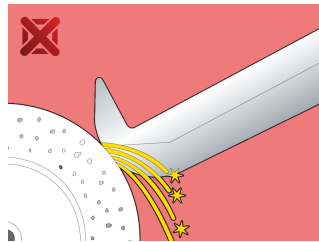
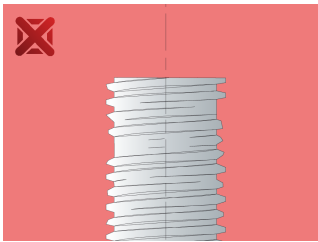

## Frequently asked questions

**Can we achieve greater pulling force using a three-arm puller compared to a two-arm puller?**

It depends on the dimensions. In principle, yes, because the force is distributed over several arms.

**One arm broke. Do I have to replace all the arms or just the broken one?**

It is necessary to change all the arms.

