

Extractor de dos brazos ajustables

680/2



Perfiles



Características del producto

- material: acero al carbono para herramientas
- forjada, templada y revenida
- protección de superficie; cromado de acuerdo con ISO 1456:2009, tornillo pavonado

- brazos ajustables en dos posiciones
- acción de palanca ajustando sólidamente los brazos bajo las partes a separar

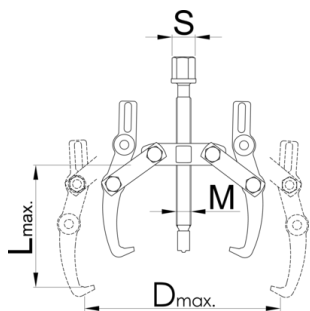

	Nº	L↑	D↑			M	S	
612603	0	90	90	20	2	M 10 x 1	13	405
601762	1	130	160	30	3	M 14 x 1,5	17	915
601763	2	190	230	40	4	M20 x 2	22	2078
601764	3	250	300	60	6	M 22 x 2	24	4075

* Las imágenes de los productos son simbólicas. Todas las dimensiones son en mm, peso en gramos.

Empleo (imágenes)

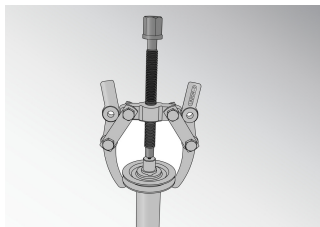

Piezas de repuesto

Pata

eje

Productos relacionados



Extractor con dos brazos corredizos



Extractor con dos brazos corredizos



Extractor de tres brazos ajustables

Seguridad (imágenes)

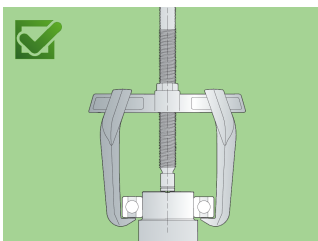
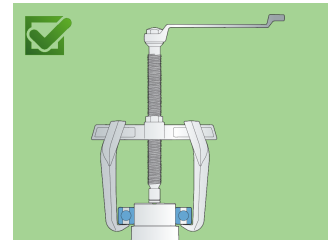
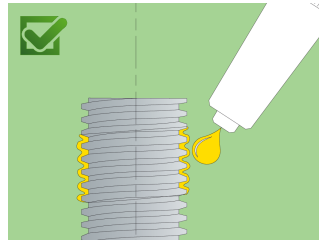
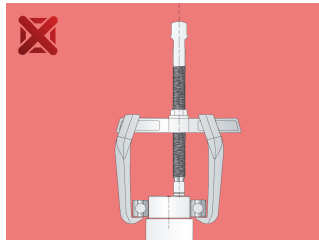
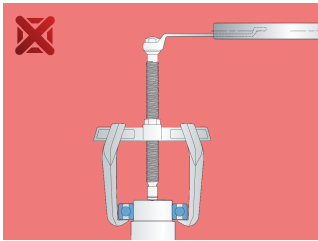
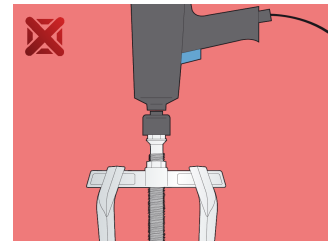
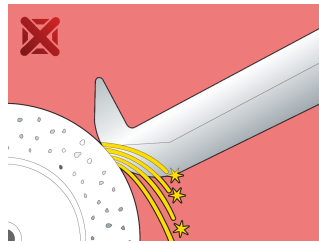
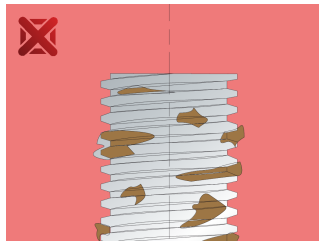
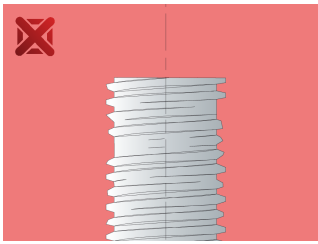

Preguntas frecuentes

Can we achieve greater pulling force using a three-arm puller compared to a two-arm puller?

It depends on the dimensions. In principle, yes, because the force is distributed over several arms.

One arm broke. Do I have to replace all the arms or just the broken one?

It is necessary to change all the arms.