

Puller with two adjustable arms

680/2



Profiles



Product features

- material: body from premium flex plus carbon steel, arm from premium chrome vanadium steel
- drop forged, entirely hardened and tempered
- surface finish: chrome plated according to ISO 1456:2009, screw blackened

- arms adjustable in two positions
- lever action claws fit closely under the part to be removed



	Nº	L↑	D↑			M	S	
612603	0	90	90	20	2	M 10 x 1	13	405
601762	1	130	160	30	3	M 14 x 1,5	17	915
601763	2	190	230	40	4	M20 x 2	22	2078
601764	3	250	300	60	6	M 22 x 2	24	4075

* Images of products are symbolic. All dimensions are in mm, and weight in grams. All listed dimensions may vary in tolerance.

Usage (pictures)

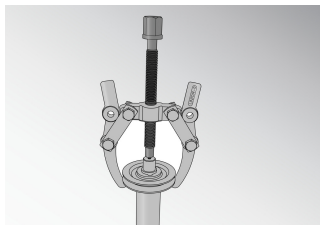

Spare parts



Arm



Spindle

Related products



Puller with two sliding arms



Puller with two sliding arms



Puller with three adjustable arms

Safety (pictures)

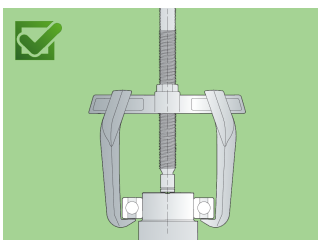
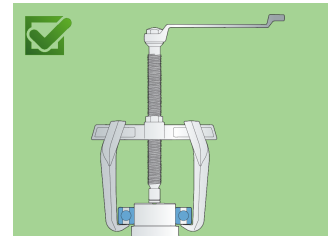
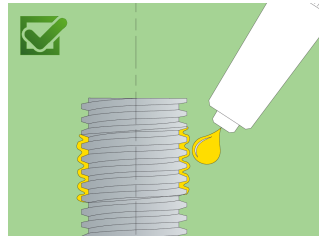
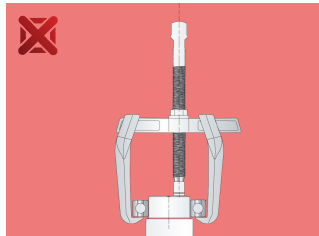
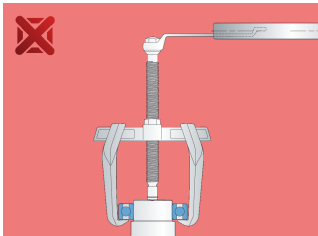
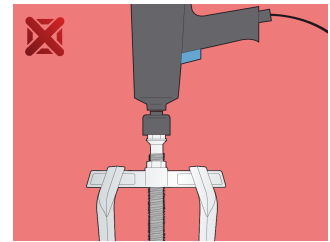
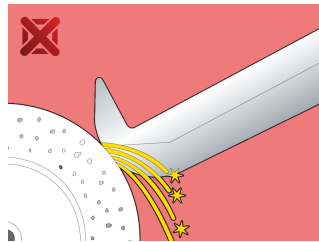
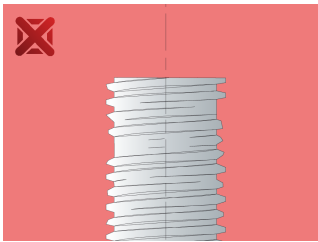

Frequently asked questions

Can we achieve greater pulling force using a three-arm puller compared to a two-arm puller?

It depends on the dimensions. In principle, yes, because the force is distributed over several arms.

One arm broke. Do I have to replace all the arms or just the broken one?

It is necessary to change all the arms.

