

# 带两个拉爪的拉拔器

680/2



## 配置文件



## 产品属性

- 材料：特种工具钢
- 落锻，完全淬火与回火
- 表面处理：根据ISO 1456:2009标准镀铬，螺钉发黑。

- 拉爪两个位置可调
- 杠杆作用下拉爪紧密贴合部件下方，然后进行拆卸

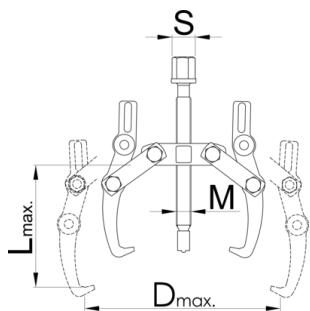

Barcode	Nº	L↑	D↑	F <sub>max</sub> →	t <sub>max</sub> →	M	S	Weight
612603	0	90	90	20	2	M 10 x 1	13	405
601762	1	130	160	30	3	M 14 x 1,5	17	915
601763	2	190	230	40	4	M20 x 2	22	2078
601764	3	250	300	60	6	M 22 x 2	24	4075

\* Images of products are symbolic. All dimensions are in mm, and weight is in grams. All listed dimensions may vary in tolerance.

## 用途 (pictures)

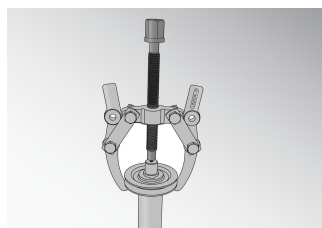

## 配件



拉爪



主轴

## Related products



带两个滑动拉爪的拉拔器



带两个滑动拉爪的拉拔器



带三个拉爪的拉拔器

## Safety (pictures)

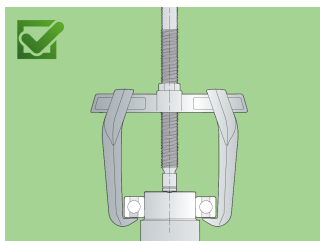
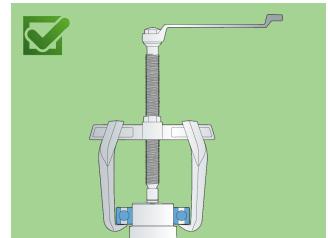
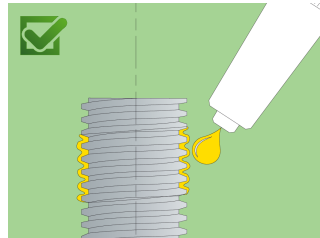
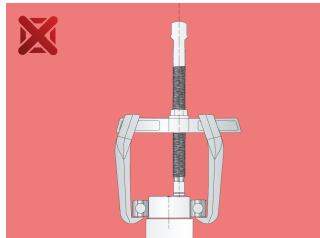
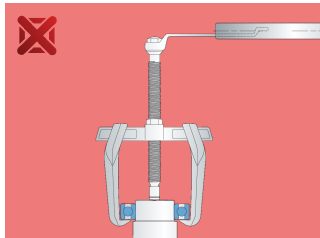
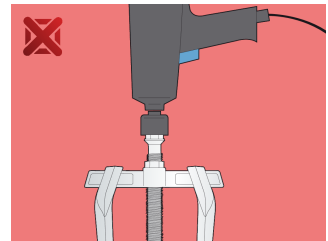
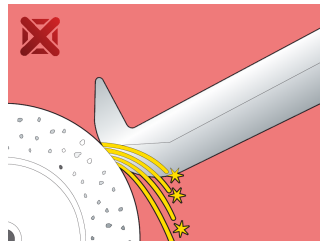
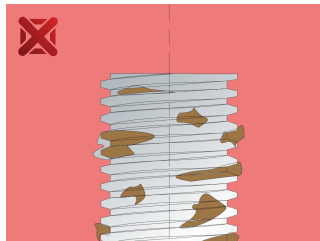
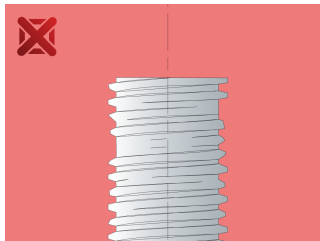

## Frequently asked questions

**Can we achieve greater pulling force using a three-arm puller compared to a two-arm puller?**  
It depends on the dimensions. In principle, yes, because the force is distributed over several arms.

**One arm broke. Do I have to replace all the arms or just the broken one?**  
It is necessary to change all the arms.

