

# Izvlakač dvokraki

680/2



## Profili



## Atributi proizvoda

- materijal: poseban alatni čelik
- kovana, potpuno poboljšana i ojačana
- završna obrada: kromiranje prema standardu ISO 1456:2009, vijak bruniran

- krakovi podesivi u dva položaja po visini
- krakove dobro pričvrstiti pod dio koji se izvlači



	N <sup>o</sup>	L $\uparrow$	D $\uparrow$			M	S	
612603	0	90	90	20	2	M 10 x 1	13	405
601762	1	130	160	30	3	M 14 x 1,5	17	915
601763	2	190	230	40	4	M20 x 2	22	2078
601764	3	250	300	60	6	M 22 x 2	24	4075

\* Slike proizvoda su simbolične. Sve dimenzije su u mm, masa je u g.

## Upotreba (pictures)

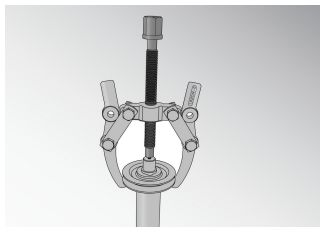

## Rezervni dijelovi

Krak

Vreteno

## Related products



Izvlakač dvokraki klizni



Izvlakač dvokraki klizni



Izvlakač trokraki

## Safety (pictures)

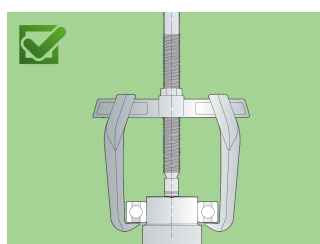
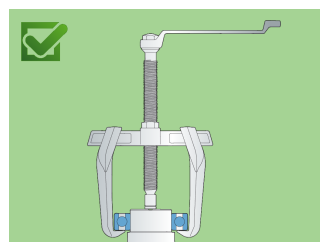
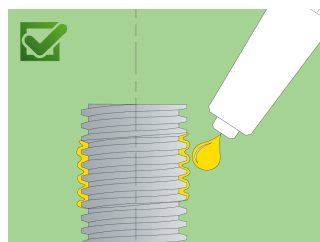
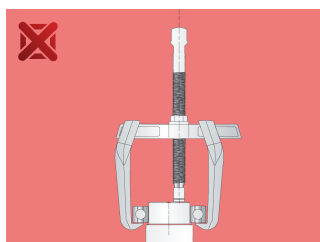
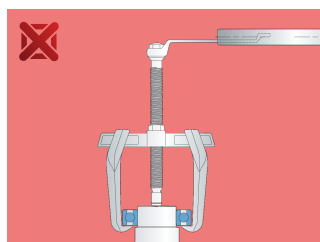
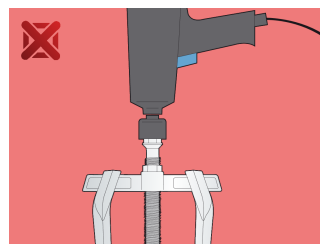
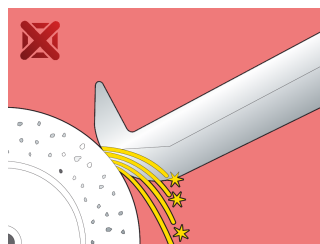
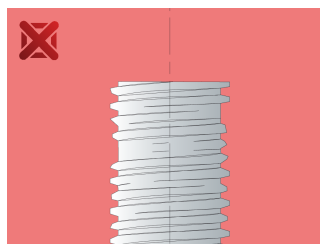

## Frequently asked questions

**Can we achieve greater pulling force using a three-arm puller compared to a two-arm puller?**

It depends on the dimensions. In principle, yes, because the force is distributed over several arms.

**One arm broke. Do I have to replace all the arms or just the broken one?**

It is necessary to change all the arms.