

# Puller with two adjustable arms

680/2



## Profiles





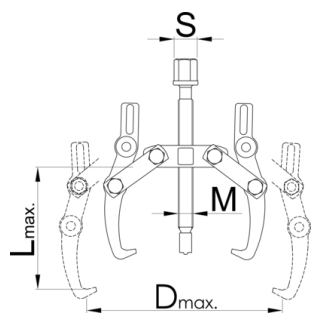

## Product features

- material: body from premium flex plus carbon steel, arm from premium chrome vanadium steel
- drop forged, entirely hardened and tempered
- surface finish: trivalent chrome plated according to ISO 1456:2009, screw blackened

- arms adjustable in two positions
- lever action claws fit closely under the part to be removed



	Nº	L↑	D↑			M	S	
612603	0	90	90	20	2	M 10 x 1	13	405
601762	1	130	160	30	3	M 14 x 1,5	17	915
601763	2	190	230	40	4	M20 x 2	22	2078
601764	3	250	300	60	6	M 22 x 2	24	4075

\* Images of products are symbolic. All dimensions are in mm, and weight in grams. All listed dimensions may vary in tolerance.

### Usage (pictures)

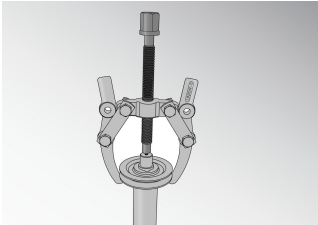

### Spare parts

 Arm

 Spindle

## Related products



Puller with two sliding arms



Puller with two sliding arms



Puller with three adjustable arms

## Safety (pictures)

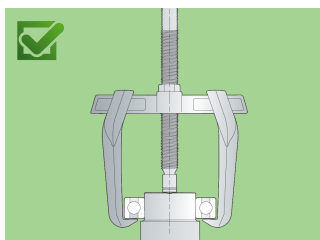
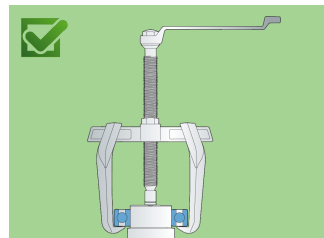
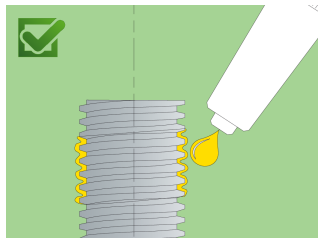
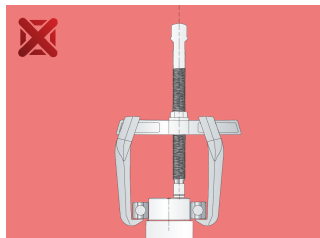
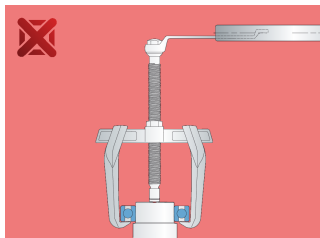
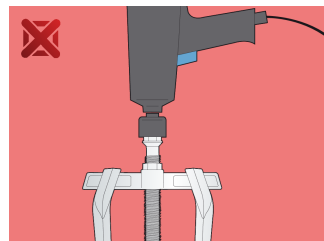
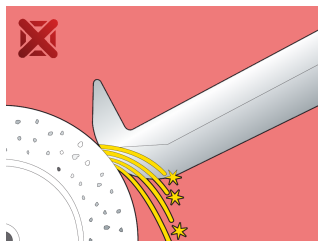
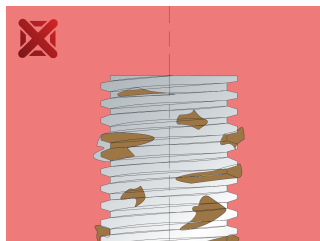
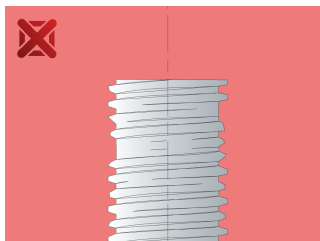

## Frequently asked questions

**Can we achieve greater pulling force using a three-arm puller compared to a two-arm puller?**

It depends on the dimensions. In principle, yes, because the force is distributed over several arms.

**One arm broke. Do I have to replace all the arms or just the broken one?**

It is necessary to change all the arms.

