

# Radapciger me 2 krahë

680/2



## Profiles



## Product features

- Materiali: çeliku të veçantë mjet
- rënie të falsifikuara, ngurtësuar tërësisht dhe nevrík
- përfundojë sipërfaqe: krom kromuar sipas ISO 1456:2009, vidhos nxiërë

- armëve rregullueshme në dy pozicione
- kthetrat veprim levë përshtaten ngushtë me pjesën që të hiqet



	N <sup>o</sup>	L <sup>↑</sup>	D <sup>↑</sup>			M	S	
612603	0	90	90	20	2	M 10 x 1	13	405
601762	1	130	160	30	3	M 14 x 1,5	17	915
601763	2	190	230	40	4	M20 x 2	22	2078
601764	3	250	300	60	6	M 22 x 2	24	4075

\* Imazhet e produkteve janë simbolike. Të gjitha dimensionet janë në mm, pesha në gram. Të gjitha dimensionet e listuara mund të ndryshojnë në tolerancë.

## Usage (pictures)

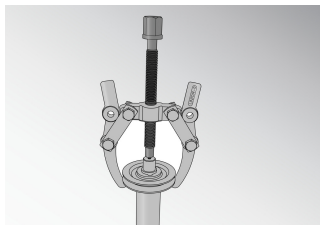

## Spare parts

Krah

Gisht

## Related products



Radapciger me dy krahë rrëshqitës



Radapciger me dy krahë rrëshqitës



Radapciger me tre krahë

## Safety (pictures)

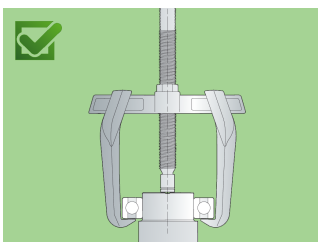
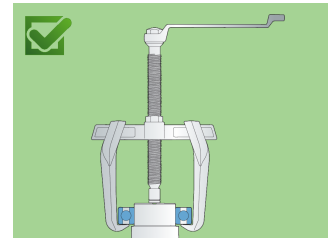
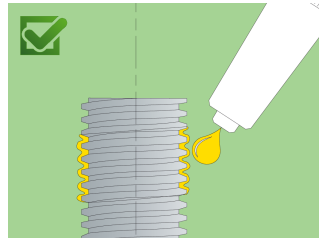
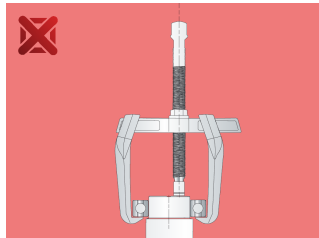
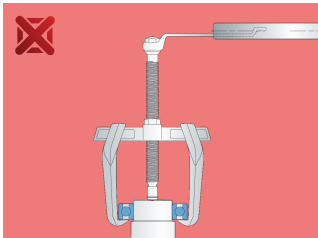
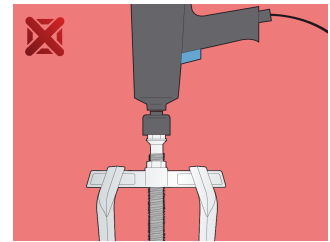
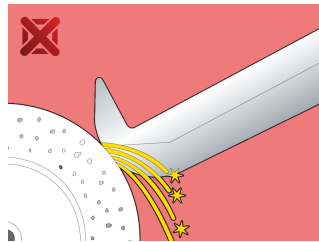
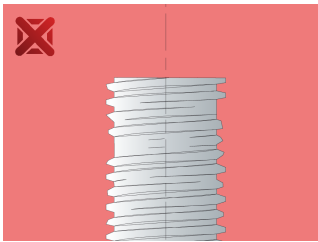

## Frequently asked questions

**Can we achieve greater pulling force using a three-arm puller compared to a two-arm puller?**

It depends on the dimensions. In principle, yes, because the force is distributed over several arms.

**One arm broke. Do I have to replace all the arms or just the broken one?**

It is necessary to change all the arms.

