

Trekker, 3-armig

682/2



Profielen



Product attributen

- material: body from premium flex plus carbon steel, arm from premium chrome vanadium steel
- drop forged, entirely hardened and tempered
- surface finish: trivalent chrome plated according to ISO 1456:2009, screw blackened
- arms adjustable in two positions

- lever action claws fit closely under the part to be removed

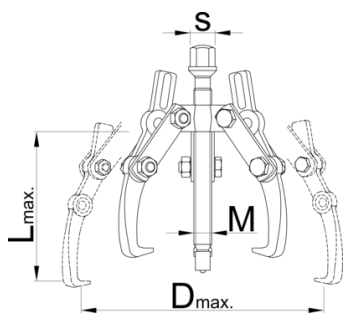

Barcode	N ^o	L \uparrow	D \uparrow	F \rightarrow _{max}	t \rightarrow _{max}	M	S	Weight
612604	0	90	90	25	2.5	M 10 x 1	13	305
601767	1	130	160	40	4	M 14 x 1,5	17	1725
601768	2	190	230	50	5	M 20 x 2	22	2570
601769	3	250	300	80	8	M 22 x 2	24	5100

* Afbeeldingen van producten zijn symbolisch. Alle afmetingen zijn in mm en gewicht in gram. Alle vermelde afmetingen kunnen variëren in tolerantie.

Gebruik (Afbeeldingen)



Onderdelen

 Arm

 Spindle

Veiligheid (Afbeeldingen)

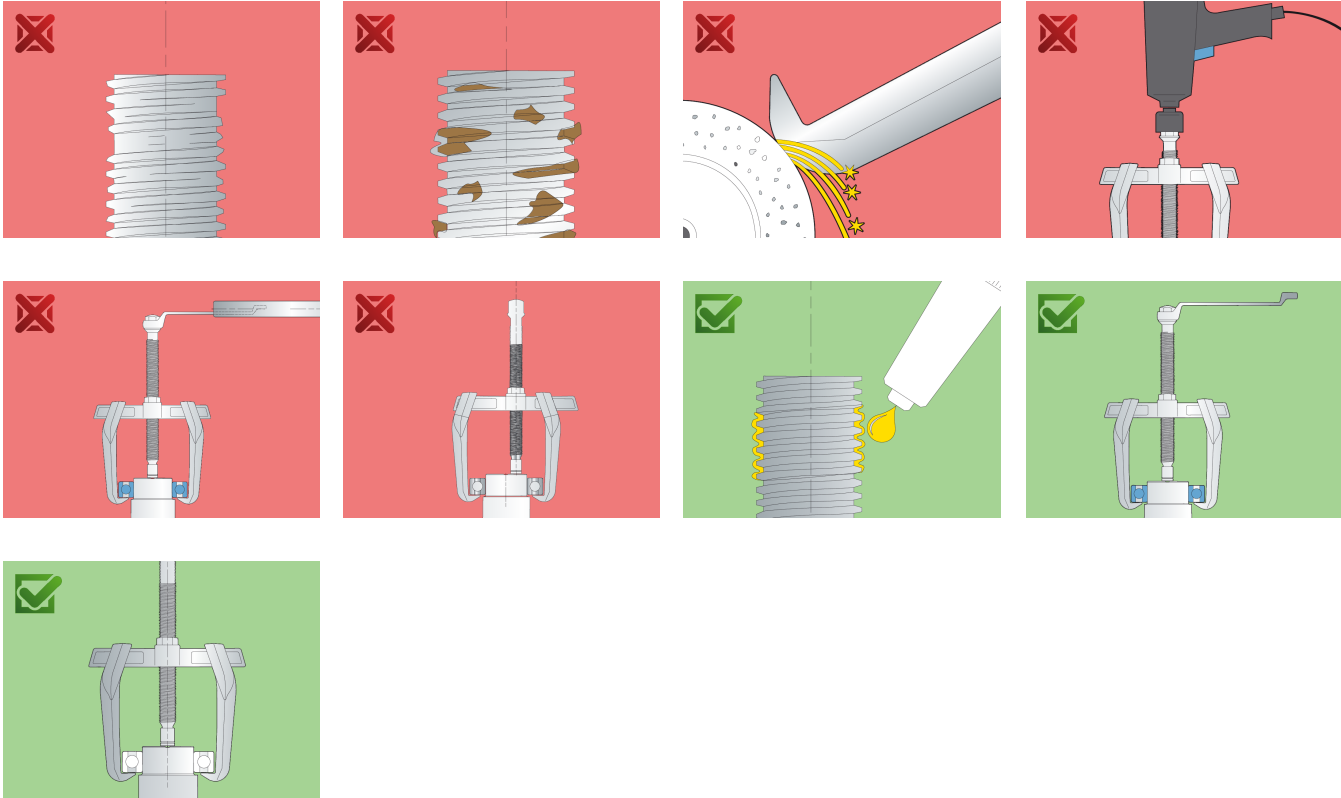

Veelgestelde vragen

Can we achieve greater pulling force using a three-arm puller compared to a two-arm puller?

It depends on the dimensions. In principle, yes, because the force is distributed over several arms.

One arm broke. Do I have to replace all the arms or just the broken one?

It is necessary to change all the arms.