

# Estrattore con tre bracci regolabili

682/2



## Profili



## Attributi del prodotto

- materiale: corpo in acciaio al carbonio plus flex premium, bracci in acciaio al cromo vanadio premium
- forgiata, interamente bonificata
- finitura superficiale: cromata ISO 1456:2009 - vite: forgiata
- bracci regolabili in due posizioni

- la leva di azionamento si aggancia fermamente sotto la parte da rimuovere

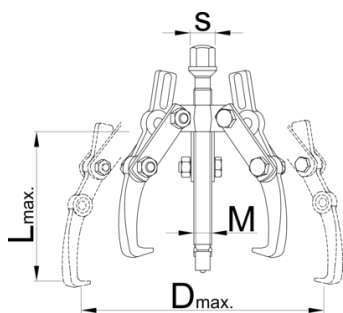

	N°	L↑	D↑			M	S	
612604	0	90	90	25	2.5	M 10 x 1	13	305
601767	1	130	160	40	4	M 14 x 1,5	17	1725
601768	2	190	230	50	5	M 20 x 2	22	2570
601769	3	250	300	80	8	M 22 x 2	24	5100

\* Le immagini dei prodotti sono puramente simboliche. Tutte le dimensioni sono in mm, peso in grammi.

### Utilizzo (pictures)



### Parti di ricambio

Braccio

Alberino

## Safety (pictures)

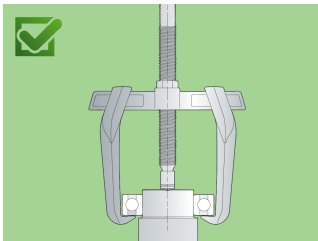
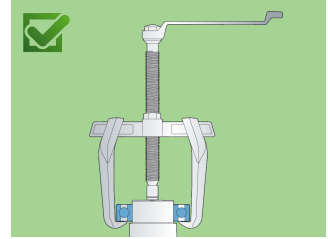
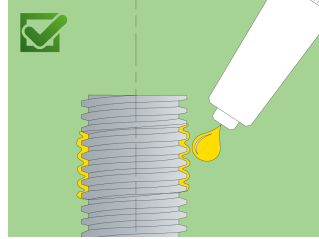
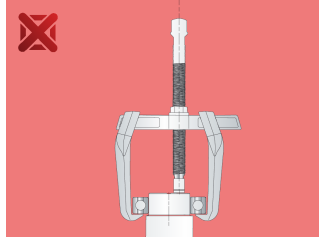
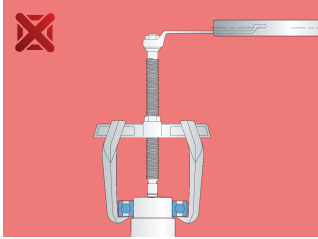
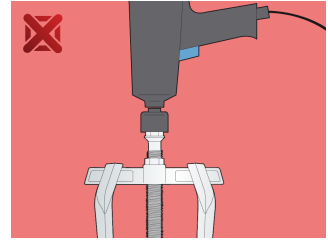
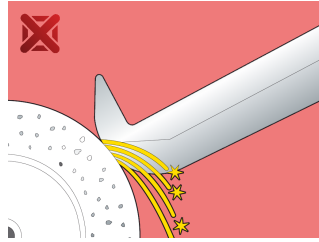
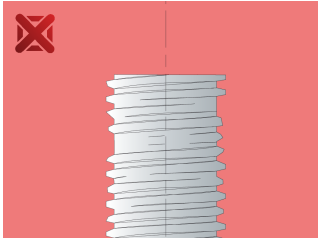

## Frequently asked questions

**Can we achieve greater pulling force using a three-arm puller compared to a two-arm puller?**

It depends on the dimensions. In principle, yes, because the force is distributed over several arms.

**One arm broke. Do I have to replace all the arms or just the broken one?**

It is necessary to change all the arms.