

带三个拉爪的拉拔器

682/2



配置文件



产品属性

- 材料：特种工具钢
- 落锻，完全淬火与回火
- 表面处理：根据ISO 1456:2009标准镀铬，螺钉发黑。
- 拉爪两个位置可调

- 杠杆作用下拉爪紧密贴合部件下方，然后进行拆卸

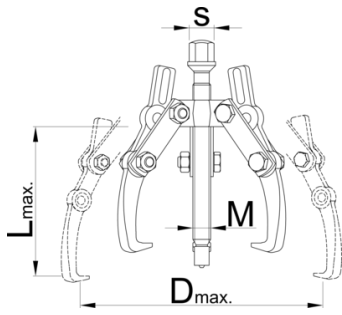

Barcode	Nº	L↑	D↑	F_{max} →	t_{max} →	M	S	Weight
612604	0	90	90	25	2.5	M 10 x 1	13	305
601767	1	130	160	40	4	M 14 x 1,5	17	1725
601768	2	190	230	50	5	M 20 x 2	22	2570
601769	3	250	300	80	8	M 22 x 2	24	5100

* Images of products are symbolic. All dimensions are in mm, and weight in grams. All listed dimensions may vary in tolerance.

用途 (pictures)



配件



拉爪



主轴

Safety (pictures)

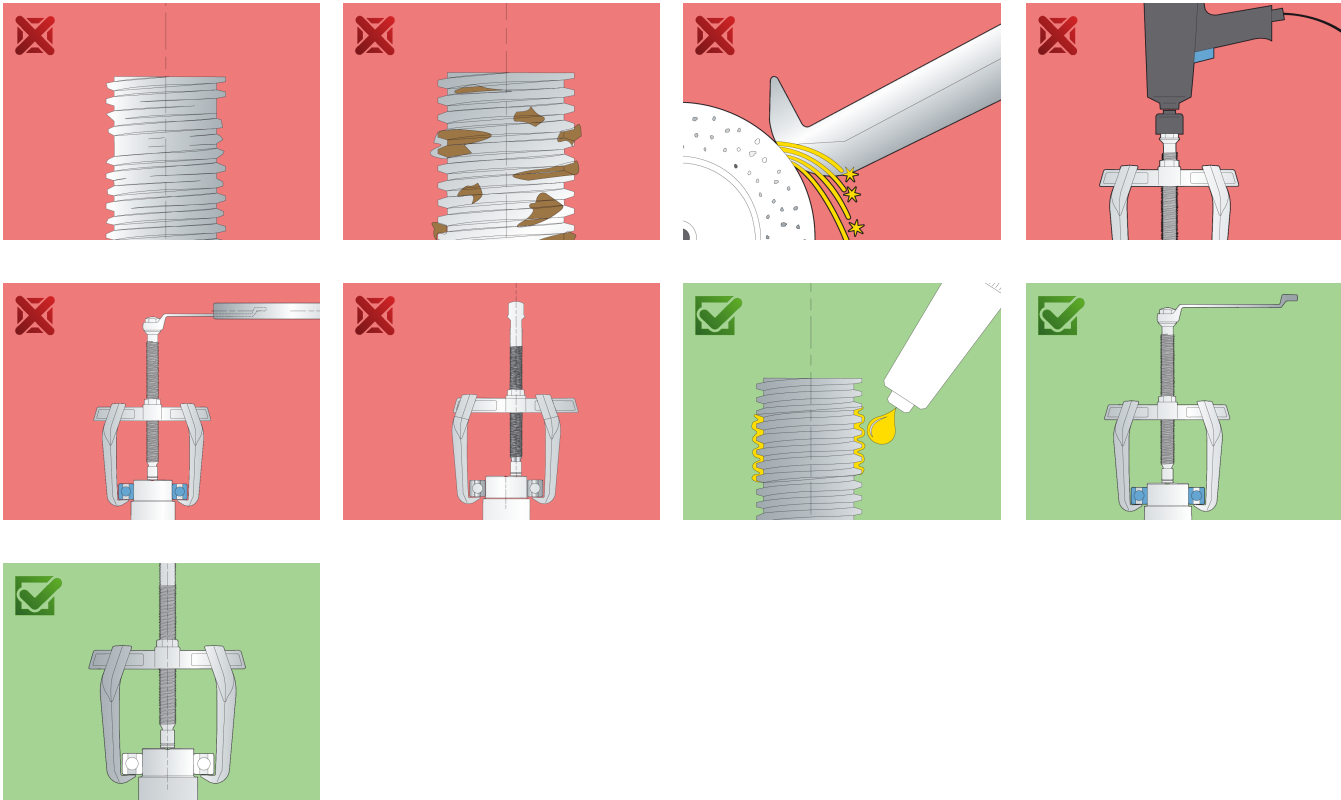

Frequently asked questions

Can we achieve greater pulling force using a three-arm puller compared to a two-arm puller?

It depends on the dimensions. In principle, yes, because the force is distributed over several arms.

One arm broke. Do I have to replace all the arms or just the broken one?

It is necessary to change all the arms.