

双十字(PZ)批头，3件套装

6466C6,3

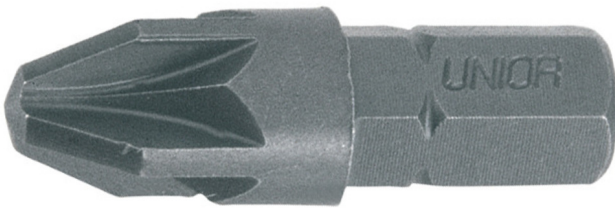

配置文件



标准

ISO 2351

产品属性

- 材料：特种工具钢
- 耐用性
- 防腐保护
- 用于手和电动驱动
- 与不同的磁性和非磁性批头托架组合
- 根据ISO 2351标准生产

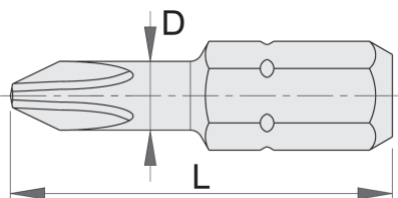

D

L





D

L



602397

PZ 1

4.5

25

10

602398

PZ 2

6

25

10

602399

PZ 3

8

25

11

* Images of products are symbolic. All dimensions are in mm, and weight in grams. All listed dimensions may vary in tolerance.