

# Altı köşe yastıklı düz tornavida

600TBI



## Profiles







## Standards

ISO 8764-1,2

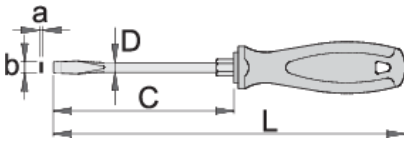
## Product features

- bıçak: krom vanadyum molibden çeliği, tamamen sertleştirilmiş ve temperlenmiş
- krom kaplamalı, kararlaştırılmış uç
- sap: ergonomik şekilli
- üç bileşenli malzeme
- asma deliği
- ISO 2380-1,2 standardına göre yapılmıştır



	axb	C	L	D		
611680	1.0 x 5.5	100	200	5	8	68
611681	1.2 x 6.5	125	235	6	10	103

	axb	C	L	D		
611682	1.2 x 8.0	150	270	7	13	143
611683	1.6 x 10.0	175	295	8	13	171

\* Ürünlerin resimleri semboliktir. Bütün boyutlar mm ve ağırlık gram cinsindedir.

### Usage (pictures)

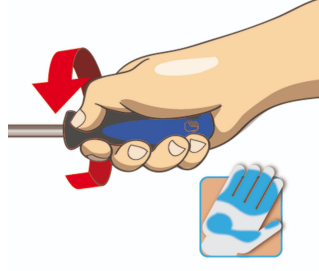

### Safety (pictures)

