

# 带六角支撑的TBI手柄一字螺丝刀

600TBI



## 配置文件



## 标准



DIN ISO 2380-1:2006 and DIN ISO 2380-2:2006

## 产品属性

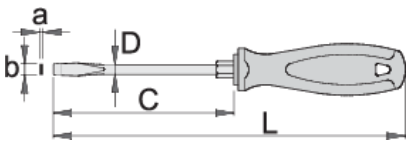
- 螺丝刀：切割器 - 特种工具钢、锻造、完全淬火与回火，完全淬火与回火
- 镀铬刀片，黑色刀头
- 手柄：符合人体工程学的形状
- 三种成分组成的材料
- 挂孔
- 根据ISO 2380-1,2标准



	axb	C	L	D		
611680	1.0 x 5.5	100	200	5	8	68
611681	1.2 x 6.5	125	235	6	10	103

	axb	C	L	D		
611682	1.2 x 8.0	150	270	7	13	143
611683	1.6 x 10.0	175	295	8	13	171

\* Images of products are symbolic. All dimensions are in mm, and weight in grams. All listed dimensions may vary in tolerance.

### 用途 (pictures)

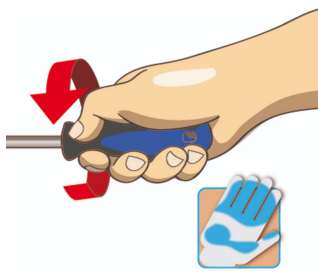

### Safety (pictures)

