

Timing pulley puller

2210/2



Profielen



Product attributen

- material: premium flex plus carbon steel
- entirely hardened and tempered
- surface finish: chrome plated according to ISO 1456:2009, screw blackened
- for removing pulleys with 3, 6, 9 slots
- This tool is designed for removing drive pulleys with face grooves. The tool removes a pulley absolutely free of any risk of damage. The tool is adaptable to different pulley diameters, as the legs are adjustable.

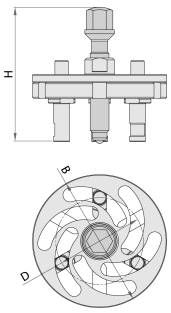

620226

100

48 - 82

135

1085

* Afbeeldingen van producten zijn symbolisch. Alle afmetingen zijn in mm, en het gewicht in grammen. Alle vermelde afmetingen kunnen variëren in tolerantie.

Gebruik (Afbeeldingen)

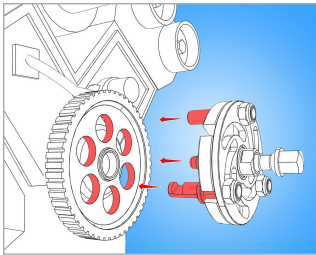

Insert puller legs into openings of pulley.

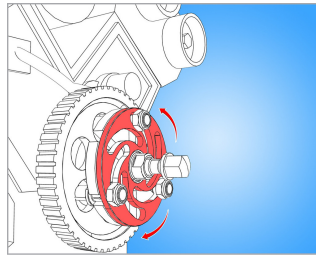

Turn setting plate to shift puller legs, so they tightly grasp to pulley.

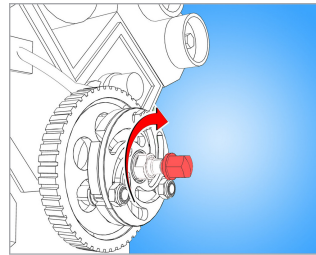

Turn spindle clockwise until pulley comes off.

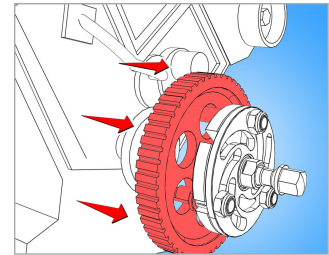

When finished working, remove puller.

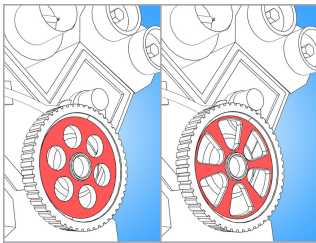

Can be used for ...



Foto (Afbeeldingen)



Onderdelen

 Spindle for 2210/2

 Arm for 2210/2

Gerelateerde producten



Universal timing pulley puller



poelietrekker

Veiligheid (Afbeeldingen)

