

Draadeindschaar

586/6



Profielen



Product attributen

- made from special forged tool steel, fitted with exchangeable jaws that smoothly cut even the toughest threaded rods up to class 8,8
- drop forged, entirely hardened and tempered
- the cutter jaws are extra hardened and tempered for enhanced durability
- the tool handles are made of powder coated steel tubes and fitted with plastic sleeves for a comfortable grip

Voordelen:

- capable to cut threaded rods of three different dimensions
- clean cutting – no burring on the threaded rod
- Preservation of the thread of the threaded rod
- protected against corrosion
- easy to operate with and comfortable handling
- precise and fast cutting of threaded rods
- the lever handle has suitable length to allow quick and uniform cutting, therefore less force is needed to cut the threaded rods
- proper opening of the cutter
- to operate correctly, the cutter should be opened by raising the top lever handle to its maximum extent. When it is fully open, insert the threaded rod into the cutter opening of the corresponding dimension

Cutting threaded rods

- 1. Insert the threaded rod into the opening of the corresponding dimension.
- 2. The threaded rod should fit tightly into the cutter thread.

Important notes when cutting

- 1. When operating on the floor, apply foot pressure on the bracket.
- 2. The cutter (code 620256) is designed to cut only M8, M10, M12 threaded rods, code 621479 cut M6, M8, M10.
- 3. The cutter is not designed to cut hardened threaded rods or bolts.
- 4. When the cutters are worn out, always replace both cutter jaws.
- possibility of replacement of damaged cutter jaws
- materiaal: premium plus carbonstaal
- cutting of M8, M10, M12 threaded rods (code 620256), M6, M8, M10 (code 621479)
- clean cut, free of burrs
- preservation of threads
- simple operation

Let op!

- prior to operation, read the instructions
- when operating, always use appropriate protective equipment

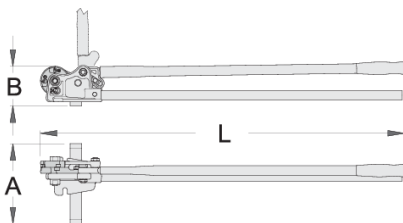

							
621479	M 6	M 8	M 10	945	95	210	5100

* Afbeeldingen van producten zijn symbolisch. Alle afmetingen zijn in mm en gewicht in gram. Alle vermelde afmetingen kunnen variëren in tolerantie.

Gebruik (Afbeeldingen)

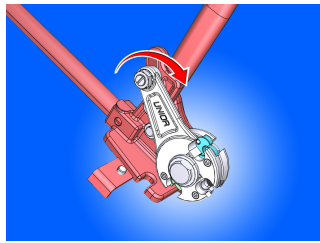

Opening the cutter; To operate correctly, the cutter should be opened by raising the top lever handle to its maximum extent. When fully open, insert the threaded rod into the cutter opening of the corresponding dimension.

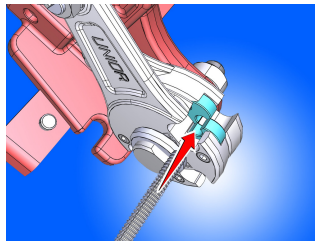

Cutting threaded rods; Insert the threaded rod into the opening of the corresponding dimension. The threaded rod should fit tightly into the cutter thread.

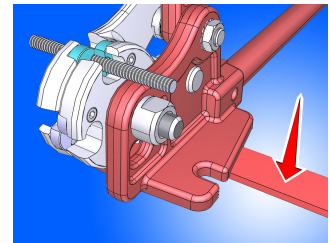

Important notes when cutting; When operating on the floor, apply foot pressure on the bracket.



Onderdelen



Snijder voor 586/6



Schroevenset 6 delig voor 586.1/7



Snijplaat - Draadcorrectie voor 586/6