

# Flywheel puller with internal thread

3054/4



## 프로파일

---



## 제품 특징

- material: premium plus carbon steel
- 표면 마감: 표준 DIN 50938에 따라 검게 처리



## 장점:

- allows flywheel removal on the motorcycle
- On the puller, there is an attachment for an open-end wrench, which should be hold the magnet

## 용도:

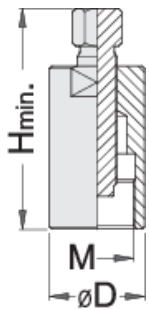
- for removal of flywheels with external thread



		D	H↑	
620270	M24 x 1,5	32	80	332
620271	M26 x 1	34	80	353
620272	M28 x 1	36	80	385
620273	M30 x 1	38	80	417
620274	M30 x 1,5	38	80	432
620275	M35 x 1,5	45	90	666
620276	M38 x 1,5	48	105	880
620277	M50 x 1,5	60	105	1254

\* Images of products are symbolic. All dimensions are in mm, and weight in grams. All listed dimensions may vary in tolerance.