

Schoteltrekker-sortiment

2026/2



Profielen



Product attributen



- material: body from premium flex plus carbon steel, arm from premium chrome vanadium steel
- Surface finish of screws: burnished, other parts are chrome-plated
- The separator puller is a tool designed to efficiently dismount various machine parts attached to shafts.

- It is indispensable for tasks requiring the safe and deformation-free dismantling of firmly fixed machine parts.
- Our product range includes three sizes of pullers used for taking off objects from shafts. They range from Ø5mm to Ø115mm.

Voordelen:

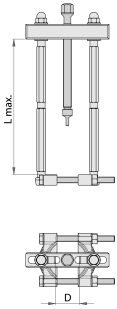
- The separator puller consists of a yoke, a spindle, two arms and a gripper assembly, which together allow uniform dismantling.
- The separator puller is designed to allow easy and safe operation



	D	$L \uparrow$	$F_{max} \rightarrow$	$t_{max} \rightarrow$	
619273	5 - 60	229	20	2	2160
619274	12 - 75	234	35	3.5	2930
619275	22 - 115	325	50	5	7180

* Afbeeldingen van producten zijn symbolisch. Alle afmetingen zijn in mm en gewicht in gram. Alle vermelde afmetingen kunnen variëren in tolerantie.

Gebruik (Afbeeldingen)

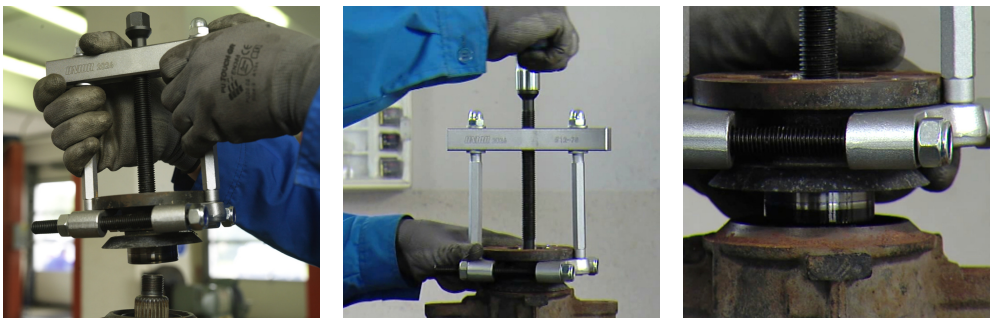

Onderdelen

 Spindle for 2026/2

 Pulling cup for 2026/2

Gerelateerde producten



Trekker, 2-armig



Trekker, 3-armig

Veiligheid (Afbeeldingen)

