

绝缘水泵钳

447/1VDEBI



配置文件



标准

DIN EN IEC 60900 (VDE 0682-201):2019-04; EN IEC 60900:2018

产品属性

- 材料：铬钒钢
- 落锻，完全淬火与回火
- 工作表面感应淬火
- 表面处理：依据ISO 1456:2009进行镀铬处理
- 重型双成分材料手柄
- 根据ISO 8976标准和EN IEC 60900生产

优势：

- 钳口有7种位置可调
- 一处特殊凸起防止钳子挤压手指

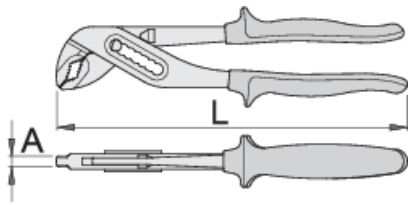

	L	A	Omax	
611993	240	6.5	35	367

* Images of products are symbolic. All dimensions are in mm, and weight in grams. All listed dimensions may vary in tolerance.

用途 (pictures)

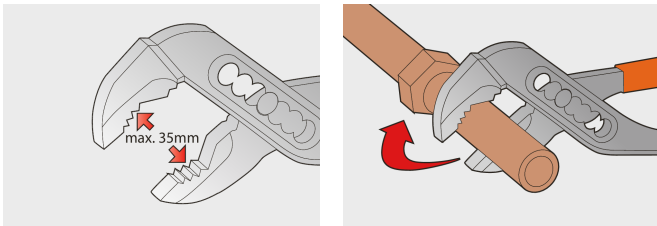

Frequently asked questions

Are certified insulated tools made through a different procedure than non-certified insulated tools?

The tools are made according to the same procedure.

Are insulated (VDE) tools considered as personal protective equipment (PPE)?

According to EU regulations, VDE tools are not considered as PPE.

Is it possible to work with insulated pliers under electrical voltage?

Yes, but only by professionals who follow safety requirements and use additional personal protective equipment.

Are the VDE tools only being sampled in series production?

The high voltage test (at 10kV) is performed fully on each tool. Other tests are performed in accordance with the EN60900 standard.